

WARRANTY

 Limited Lifetime – Residential
 Limited 10-year – Commercial

Manufactured from Swanstone solid surface
 (see page 2 for detailed information)

Recommended for high use traffic areas and commercial surfaces
FEATURES

- Ideal double-bowl for recreation vehicles, boats and other limited spaces
- Renewable surface will not wear away
- Hot pots and boiling water will not harm it
- Highest resistance of impact from heavy objects
- Easily accommodates all faucet styles
- Heat, stain and scratch resistant for lasting beauty
- Matching or contrasting countertops available. Contact a Swanstone representative for more information.

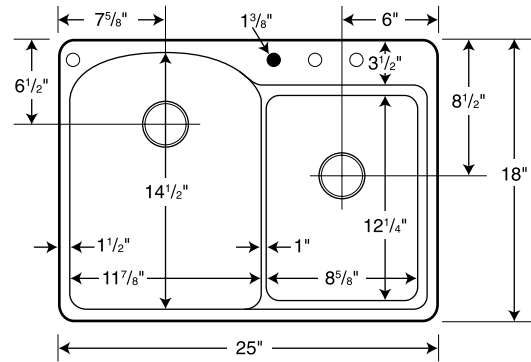
 Capacity:
 Large: 4 gallons
 Small: 2-1/2 gallons

○ Drill Points ● Pre-drilled

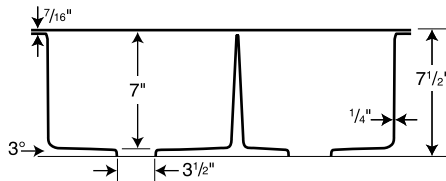
SPECIFICATIONS
KSDB-2518 Space-Saver Double Bowl

Model	Part	Dimensions	Ship Wt. Lb.	Ship UPS	Carton Dims. In.	Cu. Ft.
KSDB-2518	KSo2518DB	25" W x 18" D (635 mm x 457 mm)	18	UPS	30 x 23 x 11	4.4

Also available in skid packs. Call for price quote.

COLORS

(See inside back cover for color sample.)

- White (010)
- Bone (037)
- Bisque (018)
- Almond Galaxy (046)
- Arctic Granite (035)
- Barley (091)
- Bermuda Sand (040)
- Gray Granite (042)
- Green Pasture (095)
- Sierra (094)
- Tahiti Blue (056)
- Tahiti Desert (050)
- Tahiti Evergreen (057)
- Tahiti Gray (053)
- Tahiti Ivory (059)
- Tahiti Matrix (058)
- Tahiti Rose (052)
- Tahiti Sand (051)
- Tahiti Terra (055)
- Tahiti White (011)
- Cornflower (063)
- Ironweed (061)
- Night Sky (012)
- Purple Sage (064)
- Wild Indigo (022)
- Winter Wheat (060)
- Indian Grass (071)
- Black Galaxy (015)
- Pebble (072)
- Seafoam (074)
- Glacier (121)
- Prairie (122)
- Acorn (123)
- Canyon (124)
- Baby's Breath (168)
- Caraway Seed (169)

STANDARDS AND RATINGS

Class 1A fire rating

American National Standard Institute—ANSI Z124.6

International Association of Plumbing and Mechanical Officials (IAPMO)—listed

cUPC listed—Certified to CSA Standard B45 by IAPMO

National Sanitation Foundation-NSF Splash Zone, -NSF Food Zone

American Society for Testing and Materials

National Electrical Manufacturers Association

For a complete list of tests and results see the Technical Data Sheet – page 131.

SUPPORT DOCUMENTS

 Installation instructions available on line at www.swanstone.com
MAINTENANCE AND CLEANING INFORMATION

 Clean your Swanstone sink by using abrasive cleaners such as Comet, Ajax, Bon Ami, Soft Scrub, etc. Use of a Scotch-Brite pad, nylon scrub pad, or Mr. Clean Magic Eraser is also recommended. Food based stains can be removed using a 50/50 bleach and water solution and soaking for 15 minutes. For rust or other mineral based stains, products such as Rust-Out or Whink are acceptable. To restore luster and extend time between cleanings, Weiman's Granite Polish is recommended. **Do not** use SOS, Brillo or other metal scouring pads.

 **MADE IN USA.**