

# ROHL®

The Experience of Authentic Luxury™

[www.rohlhome.com](http://www.rohlhome.com)

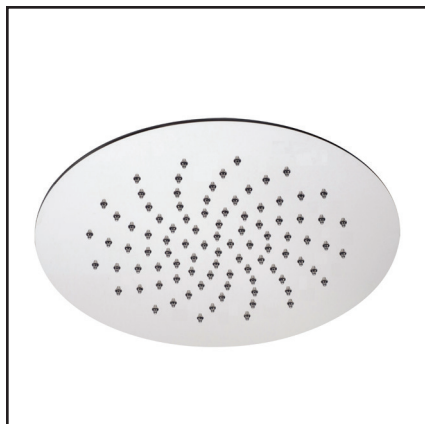

## 9 1/4" ROUND ULTRA THIN RAIN SHOWERHEAD

Spa Shower

**SLM02**

### FEATURES

- Single-function Rain showerhead
- 9 1/4" diameter faceplate
- Type 304 Stainless Steel construction
- Flexible calcium resistant nozzles on spray face allow for easy removal of hard water build-up
- Unique 1/8" ultra thin design
- 1/2" female inlet with swivel connection
- Flow rate 2.0 GPM
- For installation on ceiling or on exposed shower arm
- False ceiling installation kit available, order KIT00006NPT
- Meets EPA WaterSense® criteria to conserve water without sacrificing performance

### COLORS/FINISHES

- Polished Chrome
- Satin Nickel

### WARRANTY

- 2-year Limited Warranty

Ø9 1/4"

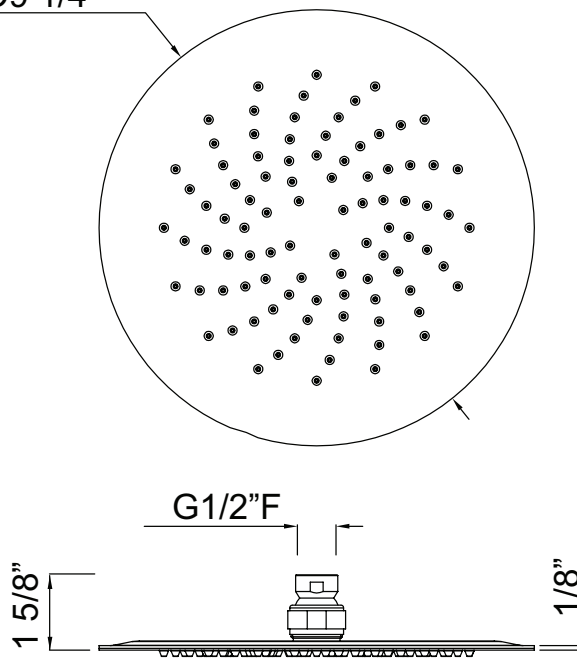

Consult your local ROHL showroom for additional information and specifications. For complete warranty details and a list of showrooms, go to [www.rohlhome.com](http://www.rohlhome.com).



# ROHL®

The Experience of Authentic Luxury™

[www.rohlhome.com](http://www.rohlhome.com)

## INSTALLATION INSTRUCTIONS

### INSTALLATION

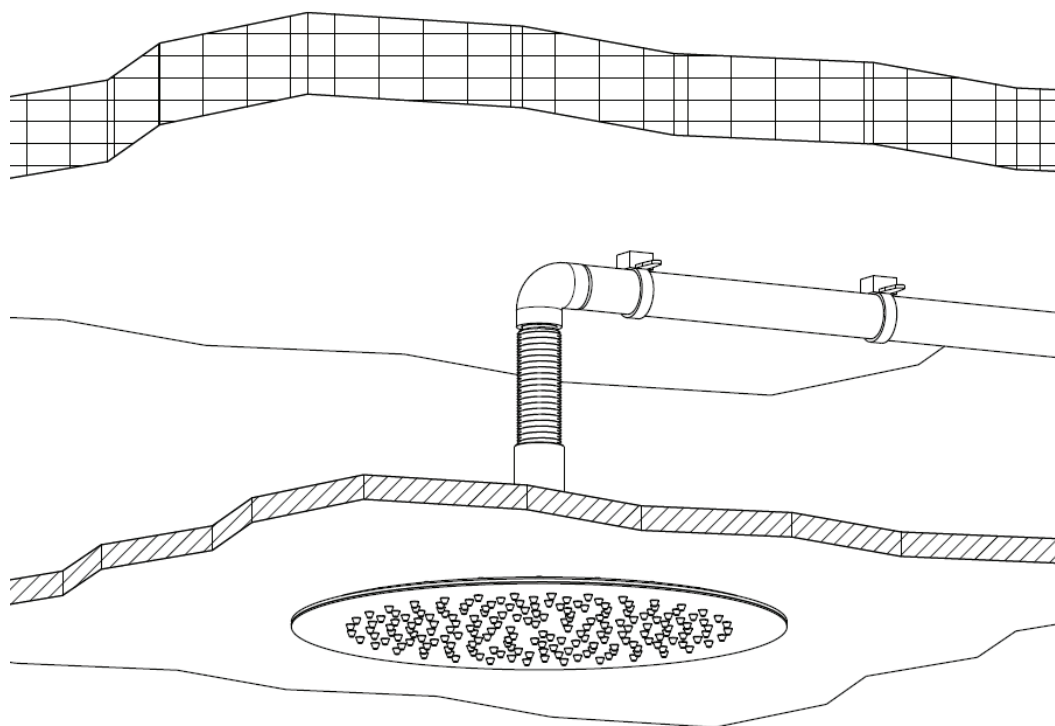

KIT MySlim SHOWER HEADS FOR FALSE CEILING

Art. KIT00006NPT

Consult your local ROHL showroom for additional information and specifications. For complete warranty details and a list of showrooms, go to [www.rohlhome.com](http://www.rohlhome.com).

# ROHL®

The Experience of Authentic Luxury™

[www.rohlhome.com](http://www.rohlhome.com)

## INSTALLATION INSTRUCTIONS



### WARNINGS:

- The plant must be made by an authorised staff and must be certified at the norms in use in the country where the installation is made.
- All the material used must be conformed to the safety requirements forecast for this type of installation, as per the norms which are effective in the country where the installation is made.
- All (hydraulic and electric) connections must be perfectly isolated one from the other and stably fixed.
- This device can be used by people over the age of 8 years and by persons with reduced physical, sensory or mental capabilities, or lack of experience, only if properly supervised or instructed on safe use of the device and with knowledge of the risks associated. Children must not play with the device. Cleaning and maintenance shall not be made by children without supervision.
- In the equipment there are no components containing mercury and asbestos.

## INSTALLATION INSTRUCTIONS

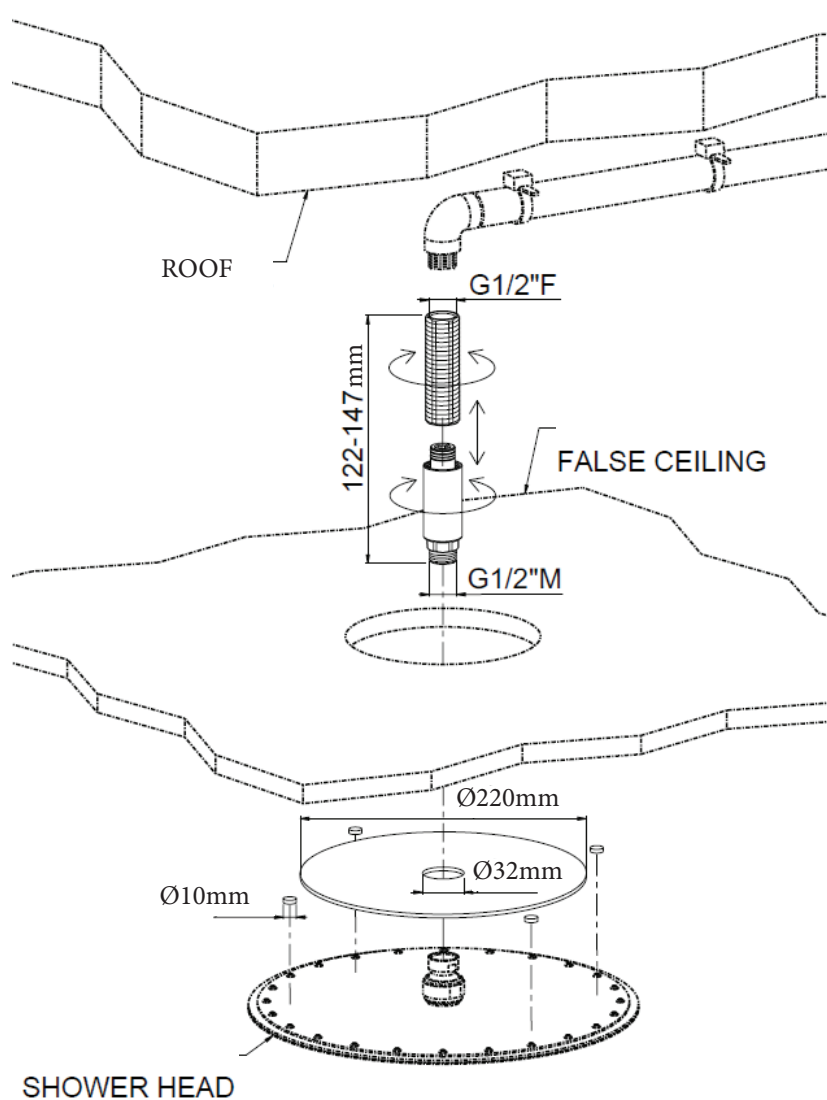

## INSTALLATION INSTRUCTIONS

### PRE-INSTALLATION

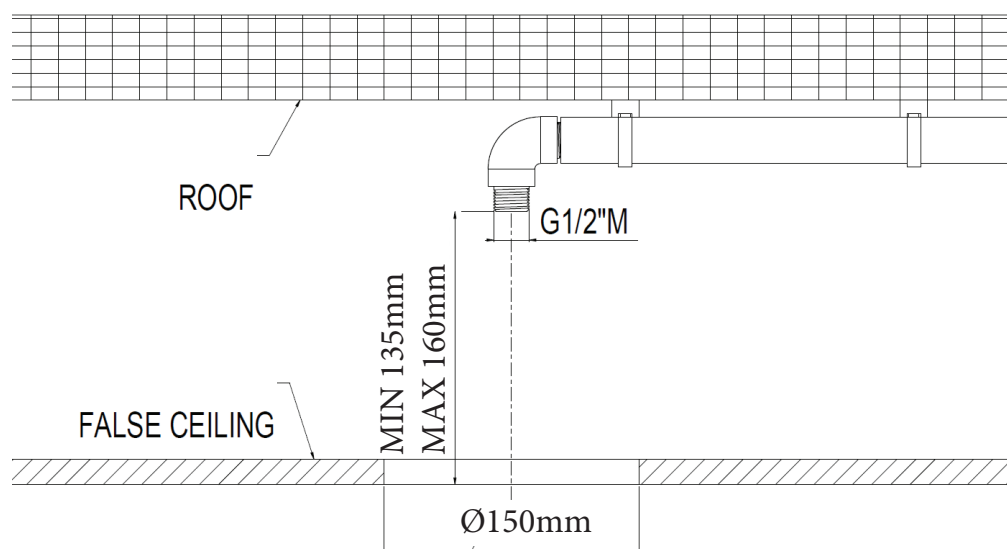

Run a pipe to the ceiling with G1/2\"M outlet for the showerhead and prepare a false ceiling that must be at a distance between 135 mm and 160 mm.

Prepare a Ø150 mm hole in the false ceiling near the pipe outlet.

## INSTALLATION INSTRUCTIONS

### INSTALLATION

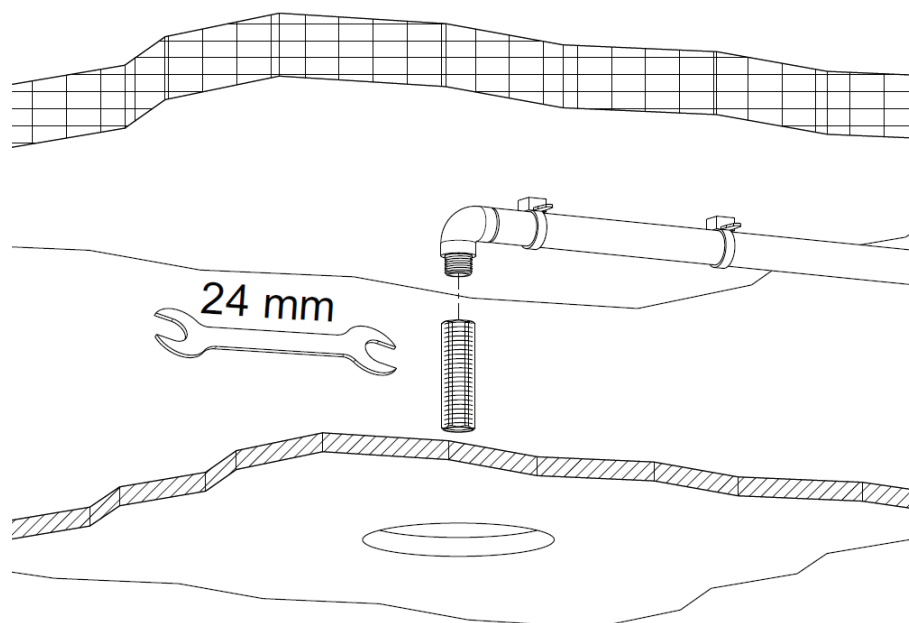

Then, screw hermetically the threaded connection using a 24 mm wrench together with hemp or similar materials.

## INSTALLATION INSTRUCTIONS

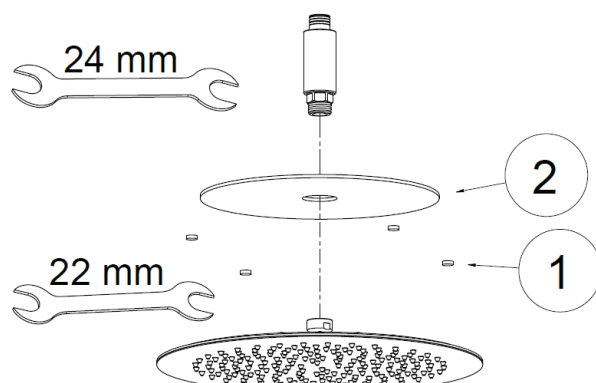

Put the felt covers (1) and the protection gasket (2) supplied on the upper shower head surface. Then, screw the kit to the shower head using a 24 mm wrench and a 22 mm wrench. The gasket (2) does not penetrate dust and/or air inside the cavity between the ceiling and the false ceiling as well as makes soundproof the area. The felt covers (1) protect the false ceiling from any possible scratches during the screwing process.

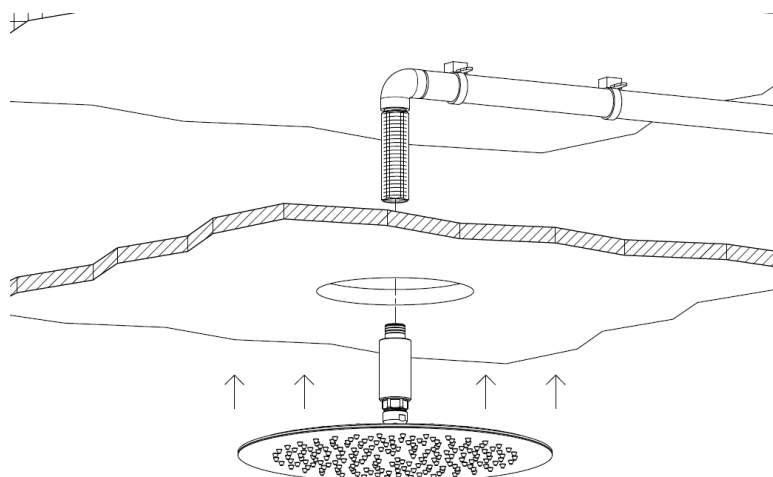

Insert the shower head with the kit installed inside the hole near the threaded connection.

# ROHL®

The Experience of Authentic Luxury™

[www.rohlhome.com](http://www.rohlhome.com)

## INSTALLATION INSTRUCTIONS

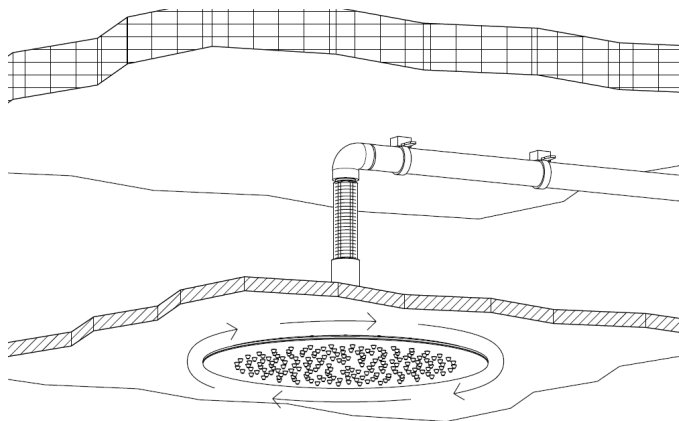

Screw by hand the shower head as shown in the picture below.

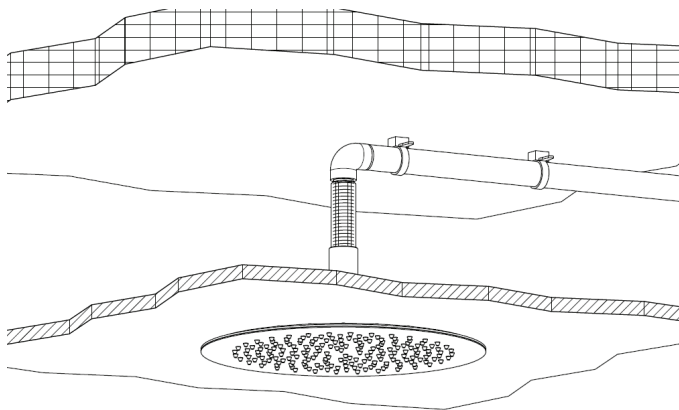

When the installation is completed, make sure that the shower head is perfectly stick to the false ceiling.  
This installation is the ideal solution for shower heads of huge dimensions and for any shower head with G 1/2 swivel.