

BILL OF MATERIAL (CURRENT LEVEL)					
ITEM	PT/ASSY	DESCRIPTION		TYPE	QTY.
1	1-506	R/T 2-VALVE, QUICK CONNECT		ASSEMBLY	1
2	10016	ESCUTCHEON BELL		PART	2
3	3-252	ROMAN TUBE SPOUT		ASSEMBLY	1
4	91231	O-RING, #2-136, EPDM, 65-75 DURO		PART	2

COPYRIGHT 2005 BRASSTECH, INC. THESE DRAWINGS AND THE DESIGNS DEPICTED HEREIN ARE THE PROPRIETARY PROPERTY OF BRASSTECH. ANY USE OR REPRODUCTION IS SUBJECT TO THE EXPRESS APPROVAL OF BRASSTECH. UNAUTHORIZED USE IS STRICTLY PROHIBITED. ALL RIGHTS RESERVED.

**BRASSTECH**  
INCORPORATED  
2001 CARNEGIE AVE.  
SANTA ANA, CA 92705  
(949) 417-5207

ROMAN TUB SET

ASSY. NO.		B	EN-2348b	12/20/13
7206		A	EN-2032	01/07/13
SCALE .400		-	RELEASED	05/30/02
REF. -	SHEET 1 OF 2	REV	REV DESC	DATE

# SPECIFICATION DWG

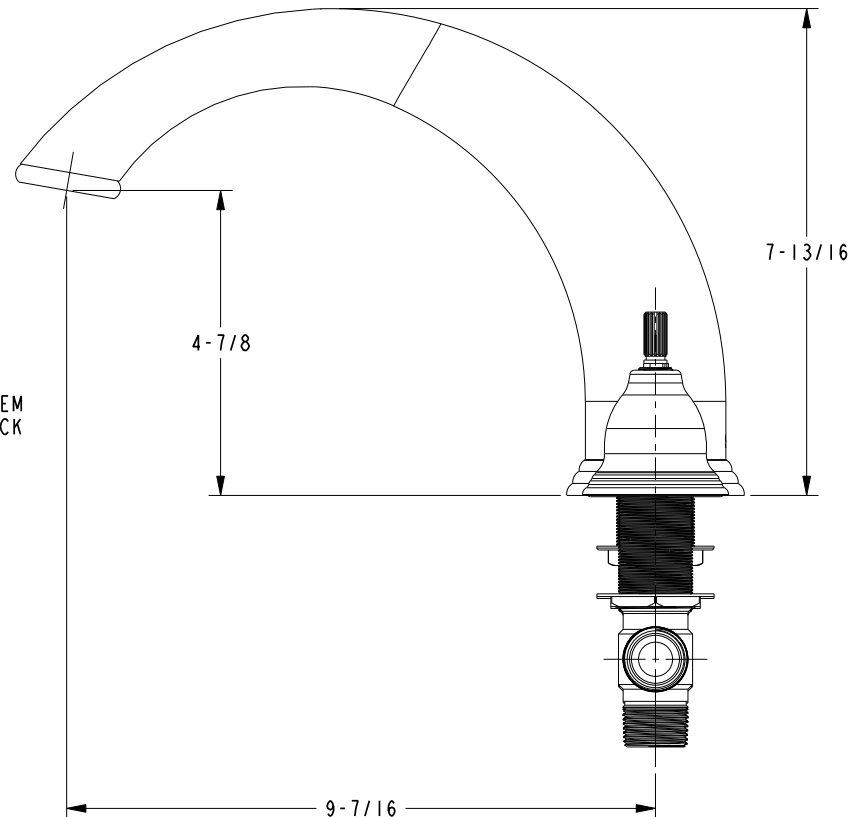
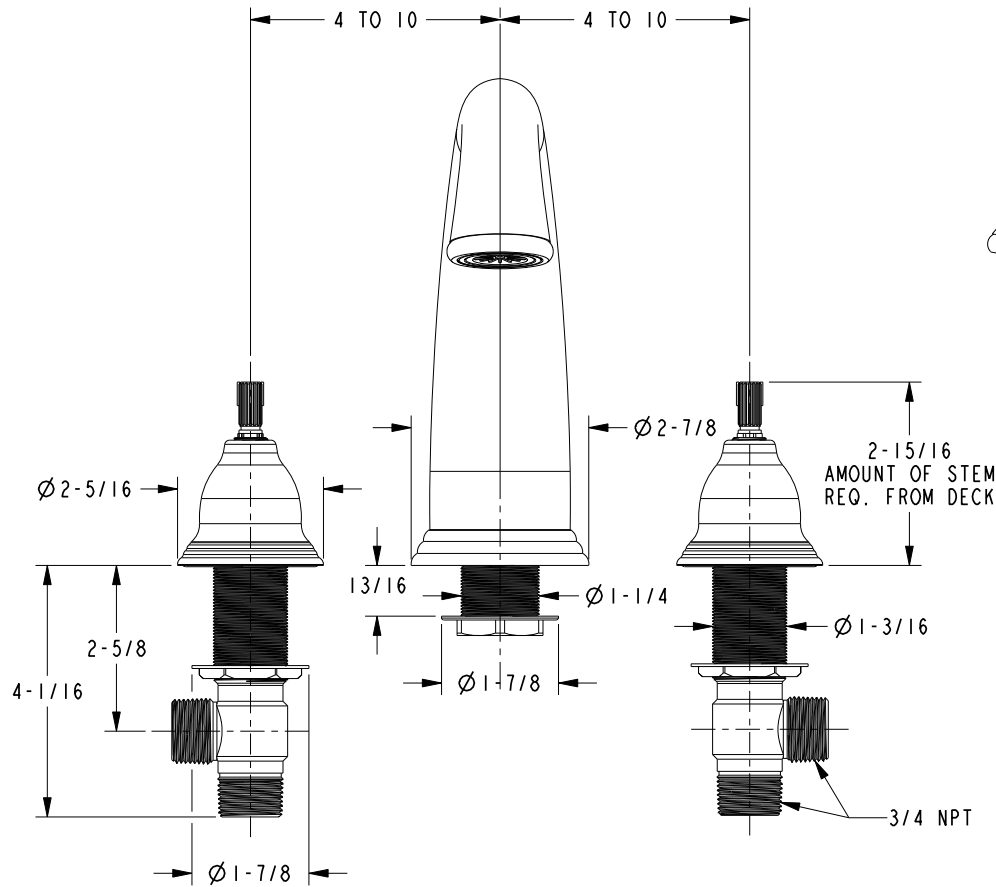

DIMENSIONS ARE IN INCHES AND AN APPROXIMATION OF A TYPICAL INSTALLATION

COPYRIGHT 2005 BRASSTECH, INC. THESE DRAWINGS AND THE DESIGNS DEPICTED HEREIN ARE THE PROPRIETARY PROPERTY OF BRASSTECH. ANY USE OR REPRODUCTION IS SUBJECT TO THE EXPRESS APPROVAL OF BRASSTECH. UNAUTHORIZED USE IS STRICTLY PROHIBITED. ALL RIGHTS RESERVED.

<b>BRASSTECH</b>		2001 CARNEGIE AVE. SANTA ANA, CA 92705 (949) 417-5207	
INCORPORATED			
DWG NO.	7206	REV	B
SCALE	.325	REF.	-
SHEET 2		OF 2	