

NOTE:



1. APPLY 15-20 IN-LB OF TORQUE.

2. APPLY A THICK LAYER (APPROX. .02" THICK) OF SILICONE GREASE ON THIS SURFACE TO PREVENT ITEM 3 (P/N 50589) OR ITEM 5 (P/N 50588) FROM FREELY ROTATES.

BILL OF MATERIAL (CURRENT LEVEL)

ITEM	PT/ASSY	DESCRIPTION	TYPE	QTY.
1	3-437	SOAP DISPENSER HEAD ASM	ASSEMBLY	1
2	50931	PUMP ASSY FOR ECONO SOAP	PART	1
3	50589	PORCELAIN BUTTON-LOTION	PART	1
4	91023	O-RING #2-019	PART	1
5	50588	PORCELAIN BUTTON -SOAP	PART	1
6	10814	PORCELAIN BEZEL	PART	1

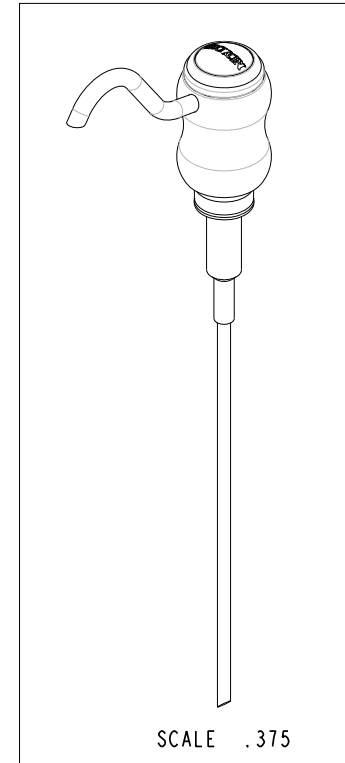
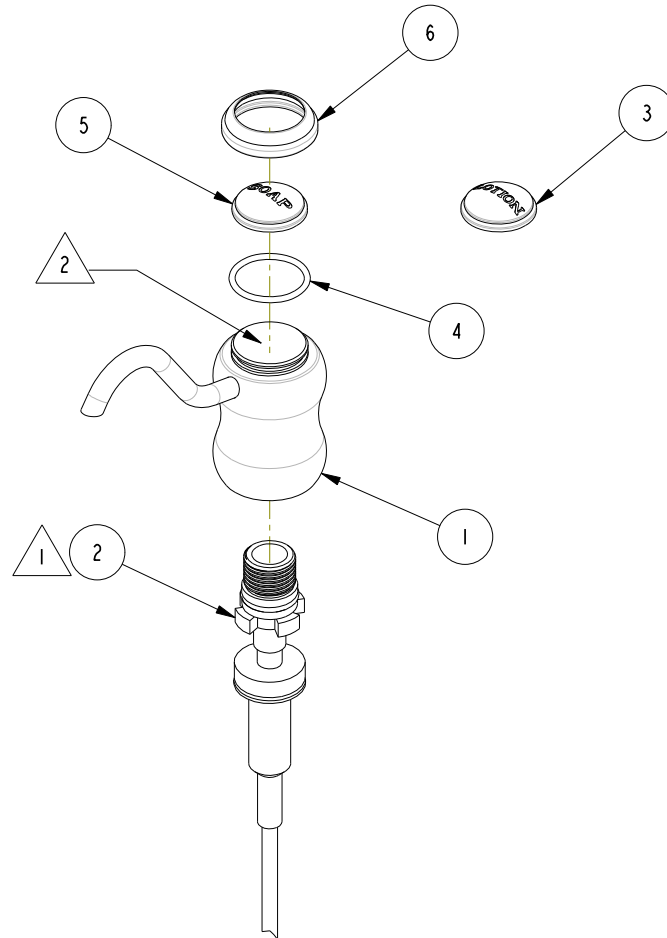

COPYRIGHT 2005 BRASSTECH, INC. THESE DRAWINGS AND THE DESIGNS DEPICTED HEREIN ARE THE PROPRIETARY PROPERTY OF BRASSTECH. ANY USE OR REPRODUCTION IS SUBJECT TO THE EXPRESS APPROVAL OF BRASSTECH. UNAUTHORIZED USE IS STRICTLY PROHIBITED. ALL RIGHTS RESERVED.

BRASSTECH
INCORPORATED
2001 E. CARNEGIE AVE.
SANTA ANA, CA 92705
(949) 417-5207

SOAP DISPENSER PUMP HEAD

ASSY. NO. 124-6

SCALE .450

REF. -

SHEET 1 OF 1

C	EN-2033	02/21/12
B	EN-1751	05/05/11
A	EN-1201	10/07/09
-	RELEASED	PRE '95
REV	REV DESC	DATE