

REPLACEMENT PARTS

NOTE:
USE SILICON GREASE (PART NUMBER 6727) TO LUBRICATE O-RINGS
AND DIVERTER BEFORE INSTALL.

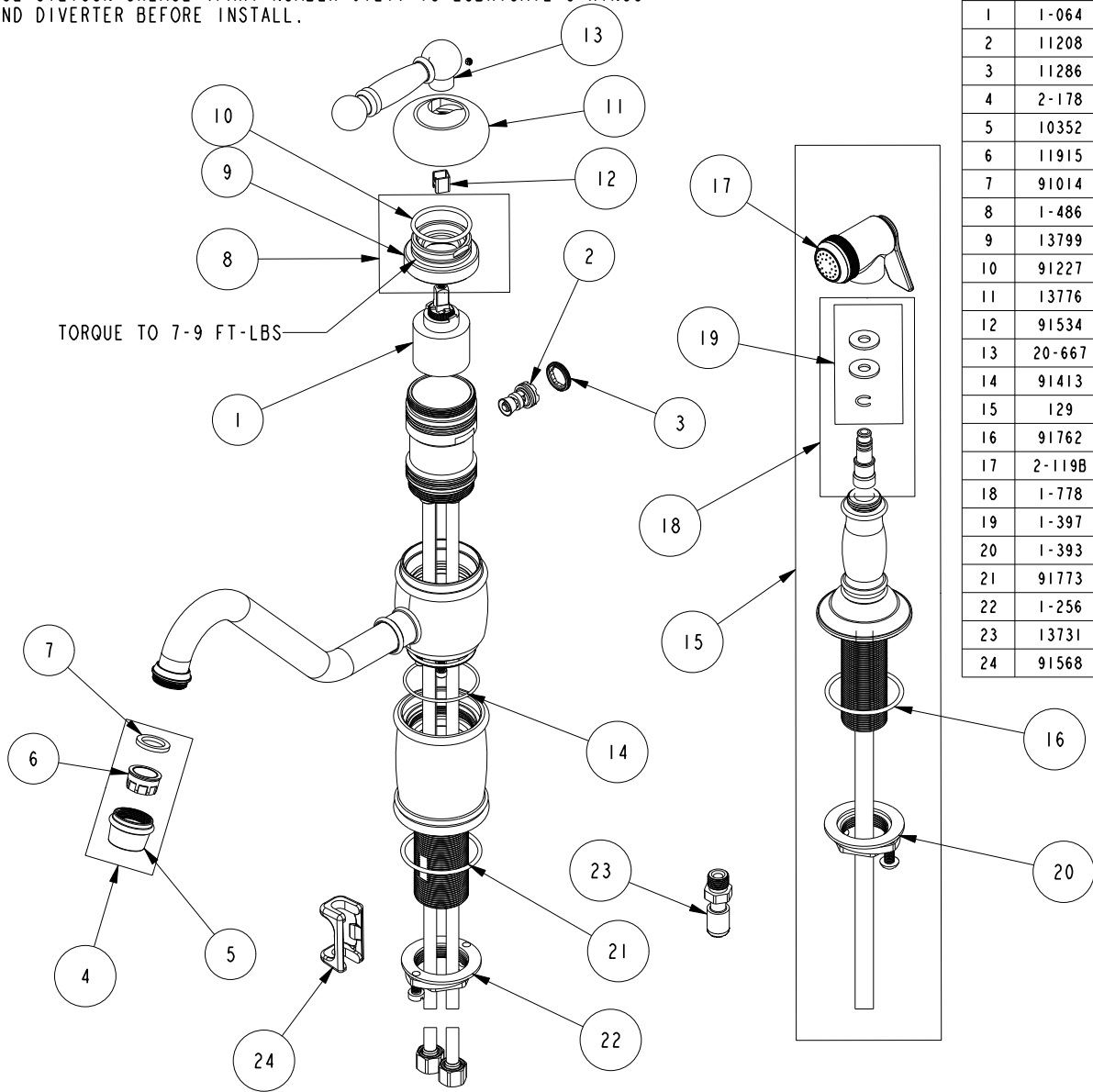

ITEM	PT/ASSY	SPECIFY FINISH	DESCRIPTION
1	1-064		SINGLE LEVER CARTRIDGE
2	11208		DIVERTER
3	11286		RETAINER RING
4	2-178	YES	AERATOR ASSEMBLY
5	10352	YES	AERATOR SHELL
6	11915		AERATOR INSERT STD, 1.8 GPM
7	91014		WSHR, .59 ID X .84 OD X .095 THK, FLT, RUBBER NSF 61
8	1-486		CART. RETAINER ASM
9	13799		CARTRIDGE RETAINER
10	91227		O-RING, #2-125 EPDM
11	13776	YES	HUB
12	91534		CARTRIDGE STEM INSERT
13	20-667	YES	ASSY, HANDLE, SINGLE LEVER
14	91413		O-RING, #2-031, PTFE, D55 DURO
15	129	YES	KITCHEN SPRAY HEAD
16	91762		O-RING, #2-132, EP, 50 DURO - GREY
17	2-119B	YES	SPRAY HEAD ASM
18	1-778		SIDE SPRAY HOSE ASSY
19	1-397		SIDE SPRAY WASHERS
20	1-393		1-1/8 18 UNEF MOUNTING KIT
21	91773		O-RING, #2-133, 50 DURO
22	1-256		MOUNTING KIT
23	13731		ADAPTER, QUICK CONNECT
24	91568		RETAINER CLIP

KIT W/SPRAY - SINGLE LEVER
941

REV R EN-4765 01/12/24 APPROVED RS

NEWPORT BRASS.

t: 949.417.5207 | www.newportbrass.com