

NOTES:

1. FIT / FORM / FUNCTION SHALL FOLLOW PS-E.008.

2 APPLY LOCTITE 680 TO THREADS

3 APPLY LOCTITE 242 TO BRACKET'S THREADS WHEN INSTALLING

BILL OF MATERIAL (CURRENT LEVEL)

ITEM	PT/ASSY	DESCRIPTION	TYPE	QTY.
1	40787	HOOK BACKPLATE	PART	1
2	40786	HOOK POST	PART	1
3	40785	HOOK FINAL	PART	1
4	28XXB	HOOK MOUNTING BRACKET	PART	1
5	1-206	HARDWARE PACK	ASSEMBLY	1
6	91790	.5" DIA. .140" HT. CLEAR RUBBER BUMPER	PART	1

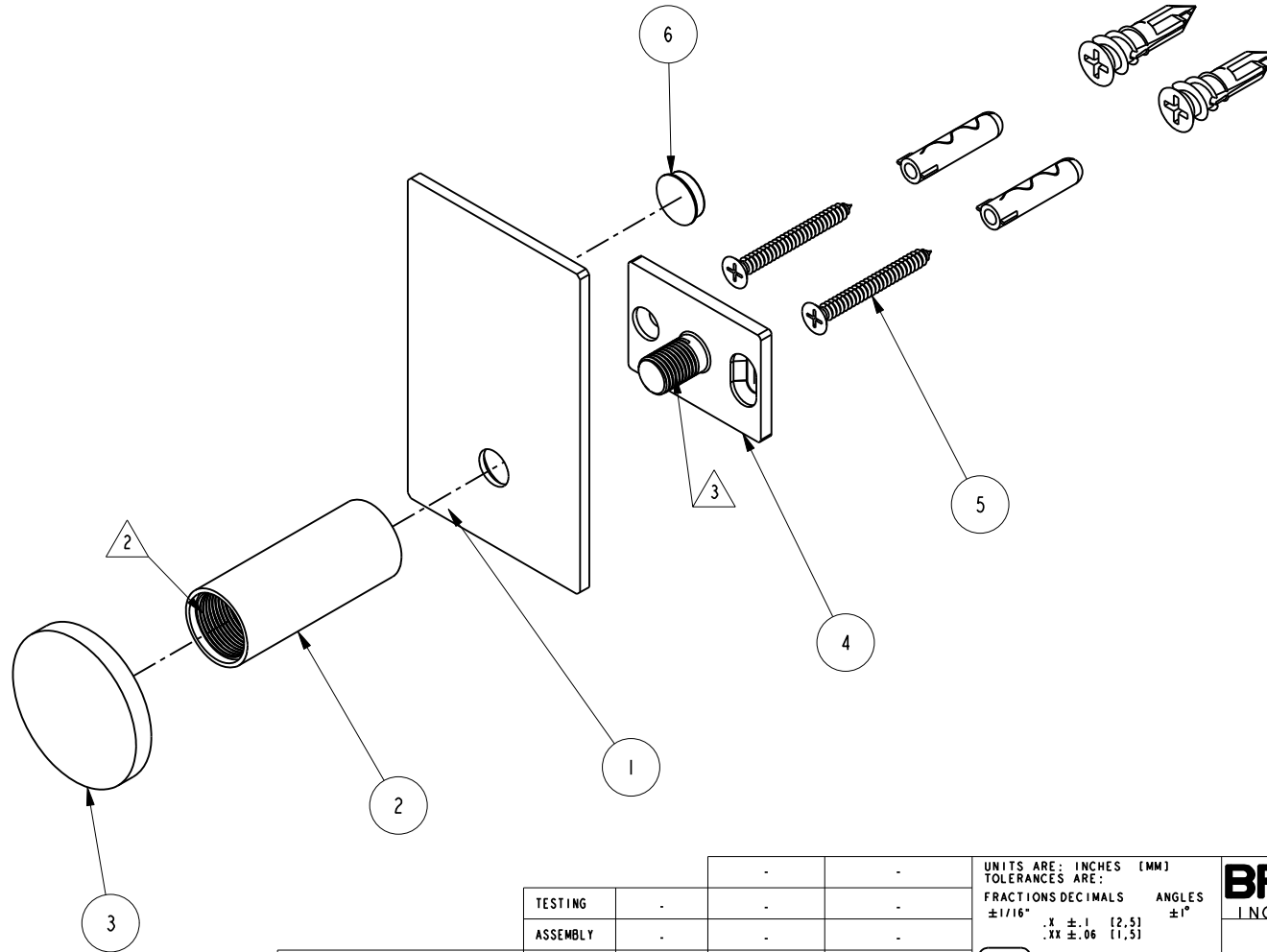

UNITS ARE: INCHES [MM]
 TOLERANCES ARE:
 FRACTIONS DECIMALS ANGLES
 $\pm 1/16"$.X $\pm .1$ [2.5] $\pm 1^\circ$
 .XX $\pm .06$ [1.5]
 (X.XXX) DENOTES CRITICAL DIMS.
 ALL THREADS ARE CRITICAL

BRASSTECH 2001 CARNEGIE AVE.
 INCORPORATED SANTA ANA, CA 92705
 (949) 417-5207

SINGLE ROBE HOOK

ZONE	REV	DESCRIPTION	DATE	APPROVED
-	A	EN-4069	01/30/20	J.M.
-	-	EN-3912	08/05/19	J.M.

COPYRIGHT 2005 BRASSTECH, INC.
 THESE DRAWINGS AND THE DESIGNS
 DEPICTED HEREIN ARE THE PROPRIETARY
 PROPERTY OF BRASSTECH. ANY USE
 OR REPRODUCTION IS SUBJECT TO
 THE EXPRESS APPROVAL OF BRASSTECH.
 UNAUTHORIZED USE IS STRICTLY
 PROHIBITED. ALL RIGHTS RESERVED.

TESTING	ASSEMBLY	PLATING	POLISHING	MACHINING	TOOLING FIXTURE #
-	-	-	-	-	
			NEXT ASSY	USED ON	
				APPLICATION	
				REMOVE ALL BURRS AND SHARP EDGES	

DRAWN	CHECKED	APPROVED
G.B. 08/05/19	J.M. 08/05/19	J.M. 08/05/19

DWG NO.	REV
2540-1650	A
SCALE .600	SHEET 1 OF 2

