

NOTES:

- 1 APPLY ADHESIVE LOCTITE 680.
- 2 APPLY TORQUE BETWEEN 8-12 LB-IN.

BILL OF MATERIAL (CURRENT LEVEL)				
ITEM	PT/ASSY	DESCRIPTION	TYPE	QTY.
1	10956	HANDLE BASE	PART	1
2	92000	SCRW, 8-32 X 1/8 SKT HD CUP PT SS	PART	2
3	12114	CRYSTAL HANDLE, ADAPTER	PART	1
4	92025	SCRW, 10-24 X 3/8 SKT HD CUP PT SS	PART	2
5	12303	CRYSTAL HANDLE, ROD	PART	1
6	12116	CRYSTAL LEVER	PART	1
7	12144	CRYSTAL HANDLE, CAP	PART	1

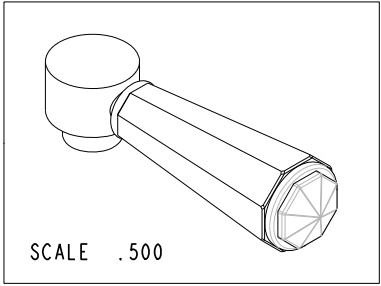
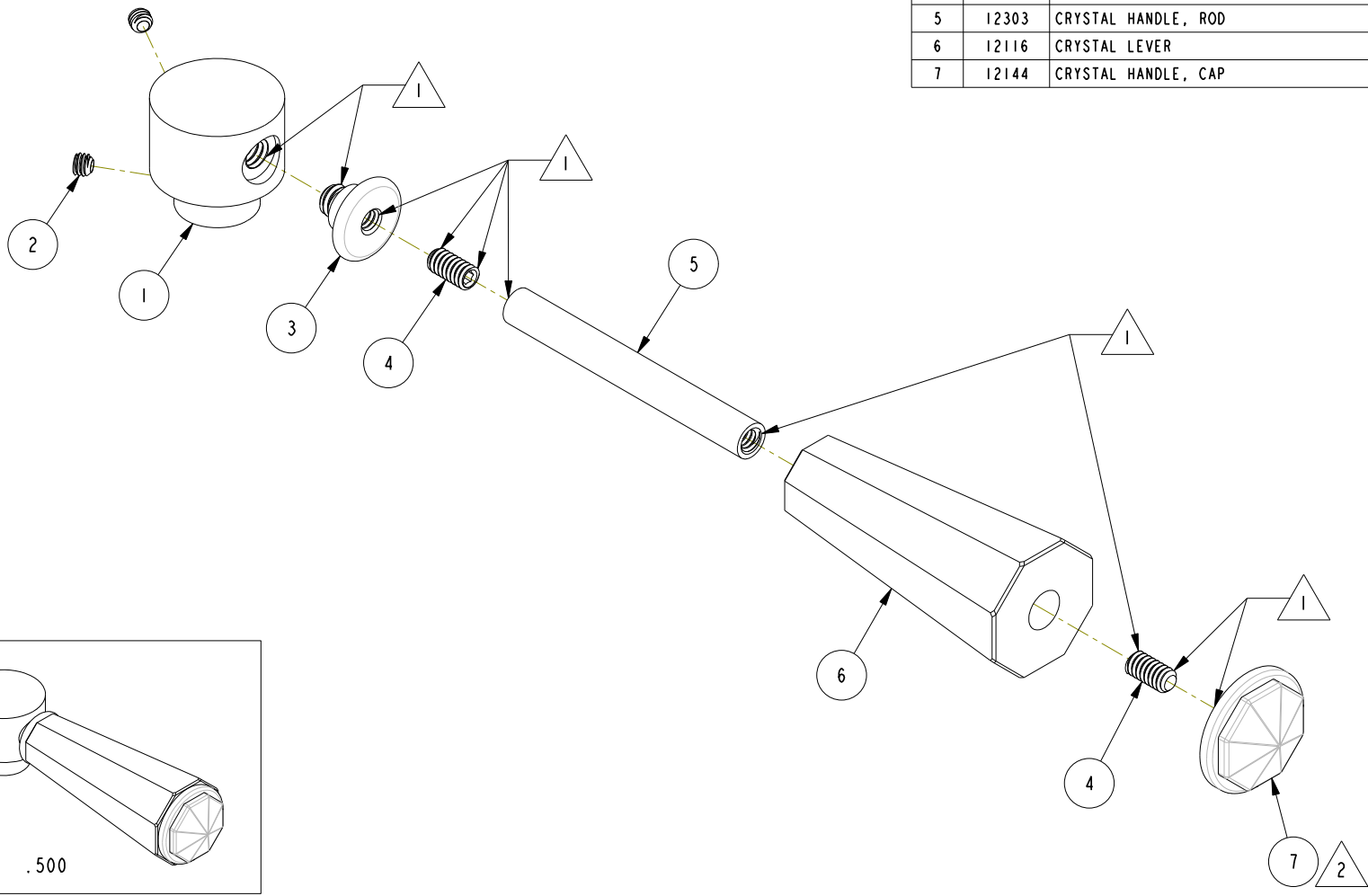

COPYRIGHT 2005 BRASSTECH, INC. THESE DRAWINGS AND THE DESIGNS DEPICTED HEREIN ARE THE PROPRIETARY PROPERTY OF BRASSTECH. ANY USE OR REPRODUCTION IS SUBJECT TO THE EXPRESS APPROVAL OF BRASSTECH. UNAUTHORIZED USE IS STRICTLY PROHIBITED. ALL RIGHTS RESERVED.

BRASSTECH
INCORPORATED
2001 CARNEGIE AVE.
SANTA ANA, CA 92705
(949) 417-5207

CRYSTAL HANDLE LEVER ASM

ASSY. NO. **2-876**

SCALE .800	REF. -	SHEET OF	REV	REV DESC	DATE
------------	--------	------------	-----	----------	------

C	EN-2723o	07/18/14
B	EN-2763	06/09/14
A	EN-2611	10/01/13
-	EN-2415	06/04/13