

Recommended Tools & Materials

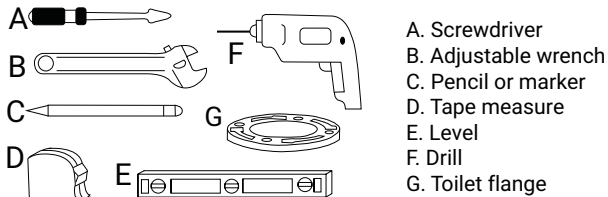

Items Included

H. Wax ring
I. T-bolts, nuts and washers
J. Supply line
K. Wax ring seal plate
L. Fixing screws and caps
M. Flange connecting brackets

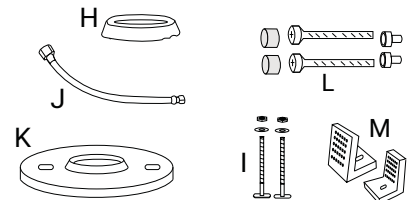

CAUTION: PRODUCT IS FRAGILE

Handle with care to avoid breakage and potential injury



Note: Illustrations in this guide are general representations and may not necessarily define the exact contours of the product.

To remove old toilet:

- Shut off water supply line to toilet. Flush toilet and remove all water from the bowl and tank using a sponge.
- Disconnect the water supply line from the tank.
- (OPTIONAL) Remove the tank from toilet base, use a screwdriver, adjustable wrench or socket wrench as necessary.
- Loosen toilet bowl flange nuts under bolt caps. Remove old toilet base by carefully lifting it off the floor.
- Clean flange and plug the drain with a rag to prevent sewer gas from escaping. **Remove rag before placing new toilet.**

Step 1. Install wax ring seal plate and connection brackets.

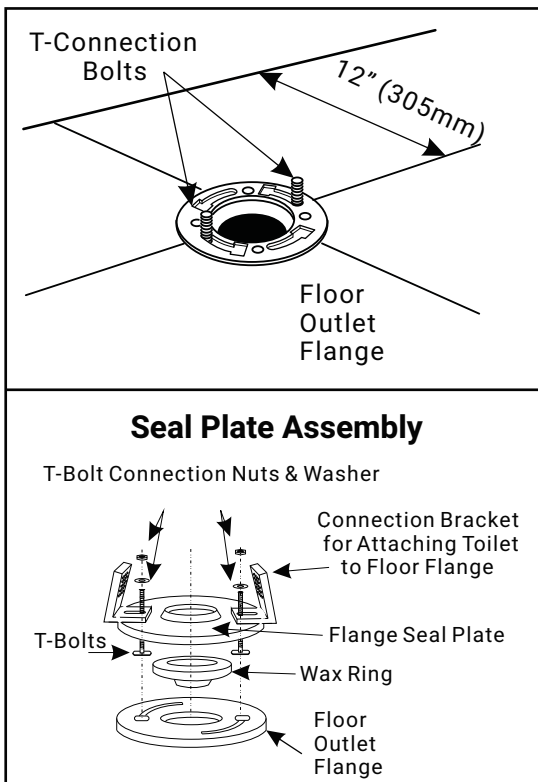

A. Place two new T-bolts into the slots on the floor outlet flange.

B. Install the wax ring onto the underside of the wax ring seal plate, then press the seal plate down evenly and firmly over the T-bolts and floor outlet flange.

C. Place the flange connection "L" brackets onto the T-bolts then attach the washers and nuts to the T-Bolt (see illustration).

D. Align flange connection brackets to the sides of the seal plate (see illustration) then tighten the nuts until snug to seal the wax ring to the floor outlet flange.

Note: This mounting assembly assumes your floor outlet flange is proud of, or even with your flooring. Recessed flanges may not seal correctly and leakage is possible. Additional sealing may be necessary in this instance.

Step 2. Install toilet base.

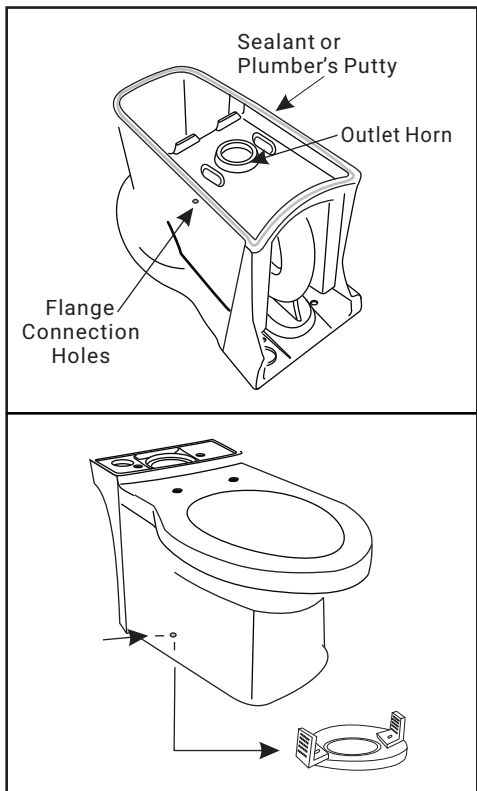

E. Place toilet base upside down on a clean surface.

F. Install a bead of sealant or plumber's putty around the foot of the base (see illustration).

G. Lift the base, flip it over and lower it into place on the floor outlet flange. Align the connection "L" brackets to the connection holes in toilet base. Bracket ears should poke through slots in toilet base.

H. Firmly push toilet down to seat the outlet horn into the rubber gasket on the seal plate assembly. Set toilet by firmly pushing down at all points around the perimeter of the base.

I. With base firmly set, insert fixing screws into screw base and then into connection holes in toilet base (see illustration).

J. Tighten screws and snap on decorative caps.

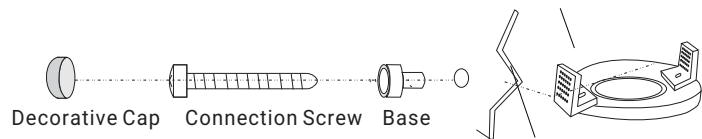

Step 3. Install toilet tank to base.

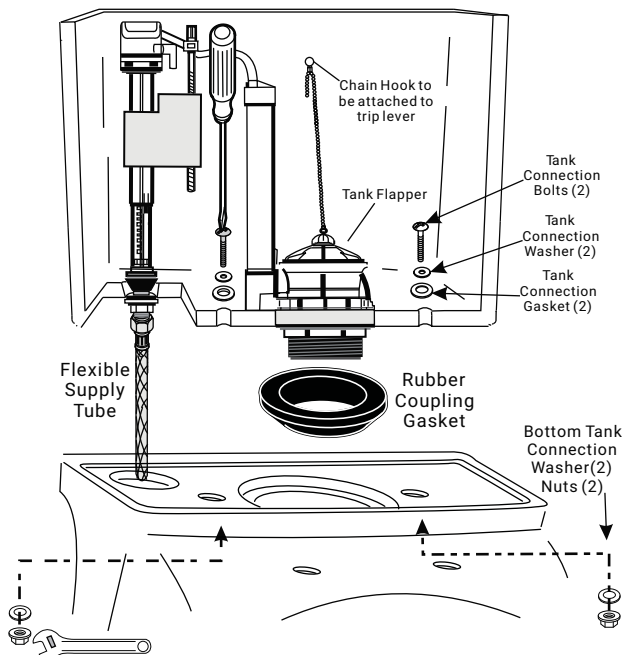

L. Lay tank on clean, stable surface and check fittings and handles for tightness. Install rubber coupling gasket by pushing onto flush valve stem.

M. Connect the flexible supply valve to the supply tube and snug this connection by hand.

N. Slide washers and rubber gaskets onto tank connection bolts and insert bolts through holes in tank.

O. Lift the tank and set it into place on the base, guiding the connection bolts through the holes in the base, and the supply tube through its hole.

P. While holding tank in position, place washers and nuts onto bolts. Tighten nuts evenly until rubber coupling gasket forms a tight seal.

⚠ DO NOT OVERTIGHTEN BOLTS! BREAKAGE WILL OCCUR! DO NOT USE SEALANTS ON TANK BOLTS, AS THIS WILL VOID THE WARRANTY!

Step 4. Connect the water supply.

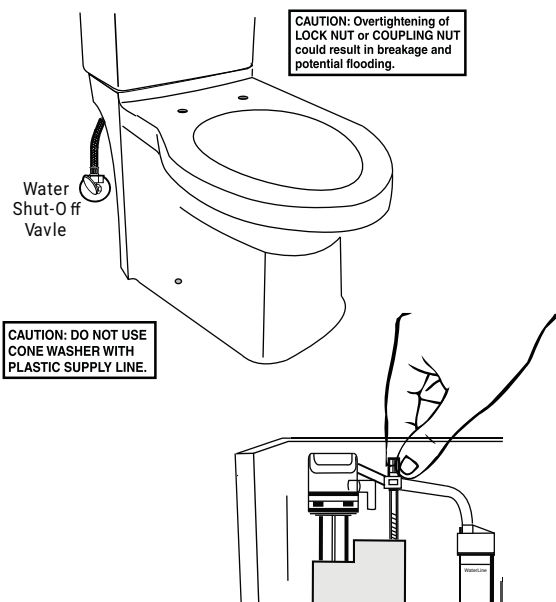

Q. Route the supply line tube from behind the bowl and connect it to the water shut-off valve.

R. Open the valve slowly and check for leaks at both the valve connection and tank connection

S. Use the thumbscrew on the fill valve inside the toilet tank to adjust waterline level to the waterline mark on the valve riser.

Step 5. Flush rod adjustment (dual-flush only)

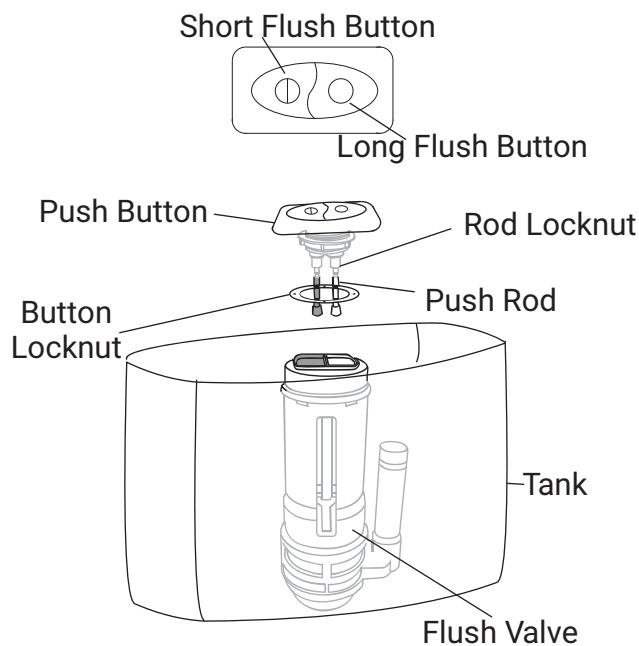

T. The flush button is pre-assembled and adjusted at the factory, but may require proper alignment and adjustment of the flush rods upon installation.

First position the lid so that it is aligned where it will sit in its final resting position, then check to make sure the button assembly also aligns correctly with the actuators on the flush valve. If adjustment is needed, loosen the button locknut and reposition. Retighten the locknut.

Second, make sure the tip of the push rods lightly touch the top of the flush valve buttons. To increase or decrease rod length, first loosen the rod locknut, then adjust the threaded rod to the desired length. Retighten the locknut to secure the rod.

Step 6. Install tank lid and seat.

U. Set the tank lid on the toilet tank.

V. To install the seat, push the quick-connect bolts through seat hinges, then push them through the seat bolt holes in toilet base. Adjust seat until it sits in required position and snug down bolts.

TANK REPLACEMENT PART INFORMATION:

The inside back of the toilet tank is stamped with replacement part information. Please record and maintain this record for future maintenance and reliable service of your new toilet.

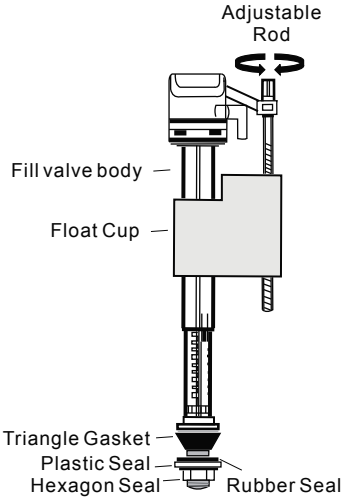
TROUBLESHOOTING	Problem	Reason	Solution
	Fill valve will not fill.	Water supply is closed? Float valve is stuck? Drain guards are stuck?	Turn on water supply at angle stop valve. Loosen fill valve nut and turn fill valve away from back of tank. Clean drain guard of debris.
	Fill valve will not stop.	Water supply continues to run? Float is stuck? Flapper is stuck open?	Turn off water and clean inside of fill valve. Loosen fill valve nut and turn fill valve away from back of tank. Check chain length and flush valve seat.
	Leaks!	Flush valve nut is loose? Fill valve nut is loose? Flapper is not seated properly?	Check that the flush valve is tightened into place. Check hex nut on fill valve to assure that it is tight. Clean flush valve seat, replace flapper if necessary.
	Poor flush.	Water level is not set to proper height? Low water pressure? Obstruction in bowl? Short flush?	Adjust the water level set screw to assure water is at the maximum level line. Make sure the minimum water pressure is above 35 PSI. Plunger the bowl and clean the drain line as necessary. Adjust the chain length of the flapper.

CARE AND MAINTENANCE

When cleaning your toilet, wash it with mild, soapy water then rinse thoroughly with clear water. Dry with a soft cloth. Avoid detergents, disinfectants or cleaning products in aerosol cans.

NEVER use abrasive scouring powders or abrasive pads on your toilet set. Some bathroom chemicals and cosmetics may damage the seat's finish.

CAUTION: This product is fragile. To avoid breakage and possible injury handle with care.

DO NOT use abrasive powder or liquid cleaners which can damage the product surface. Overtightening of the locknut or coupling nut could result in breakage and flooding.

DO NOT use the supplied cone washer with a plastic supply line.

DO NOT use pipe dope or other silicon-based materials to tighten supply coupling nut.



WARNING!

**DO NOT USE IN-TANK TOILET BOWL
CLEANERS CONTAINING
BLEACH OR CHLORINE**



Use of such products will:

1. Result in damage to tank components and may cause flooding and property damage.
2. Void the manufacturer's warranty.

MISENO PLUMBING FIXTURES LIMITED WARRANTY

What is the warranty period?

The warranty is for ten (10) years from date of purchase on the tank and base, of either the product or the home. The ballcock, flush valve and trip lever are warranted for one (1) year from date of purchase.

Who is covered?

The warranty covers the original purchaser or first home owner.

What does the warranty cover?

The warranty covers the vitreous china product that is defective in materials or workmanship.

What does the warranty not cover?

Failures to fittings due to chlorine or other chemicals.
Installation and labor costs you incurred for replacement.
Repair costs and damage due to leaks from supply line failures.
Products not installed per Miseno's instructions.
Product that were subject to abuse or misuse.
Products that do not meet local building code requirements.
Products with faulty maintenance.

What will Miseno do to correct problems?

We will repair or replace the product with a replacement model.

What do you do to get service or order replacement parts?

You may contact the place of purchase, or contact Miseno at infoservice@miseno.com.