

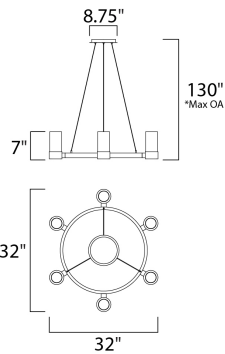

**PRODUCT DESCRIPTION**

The Silo collection makes artful use of thin-profile rectangular tubing with a mirror-like Polished Chrome finish for a clean, contemporary look. A subtle Frost on the underside of the two cylindrical glass shades adds softness to the sleek lines, while the bright Xenon lamps are cleverly concealed in the cast metal ring allowing ample light to cast both upwards and downwards without glare.



\*max overall height

**MEASUREMENTS**

DIMENSION : 32." W x 7." H  
 MAX OAH : 130." OAH  
 CANOPY : 8.75" W  
 HANGING WEIGHT : 14.96 lb

**LAMPING**

INPUT VOLTAGE : 120V  
 LUMENS : 10,400 Rated  
 BULB : 8 x 40W (INCLUDED), 320W Total  
 DIMMABLE : Dimmable  
 COLOR\_TEMP : 2900K

**FINISHES OPTION**

Polished Chrome PC



**GLASS**

Clear/Frosted CLFT

**MATERIAL**

Steel

**RATINGS**

Dry Location  
 Dimmable



**ADDITIONAL**

INSTALL UP/DOWN:  
 RATED LIFE 2000 Hours  
 OPERATING TEMPERATURE:  
 -20°C (-4°F), 40°C (104°F)

Always consult a qualified electrician before installing any lighting product.



**WESTERN DISTRIBUTION CENTER (HEADQUARTER)**  
 253 NORTH VINELAND AVE | CITY OF INDUSTRY, CA 91746  
**EASTERN DISTRIBUTION CENTER**  
 4200 SHIRLEY DR. | ATLANTA, GA 30336  
 P. 626.956.4200 | F. 626.956.4225 | maximlighting.com