

Features

- Includes face plate with cross handle
- Single cross handle controls temperature setting
- Complements the Composed faucet and accessory collection.
- Intended for use with K-2972 & K-2975 Series MasterShower Thermostatic Valves

Material

- Premium material construction with metal handle ensures reliability and durability
- Kohler finishes resist corrosion and tarnishing, exceeding industry durability standards

Installation

- Trim set requires valve to complete installation
- Patented K-joint installation technology ensures consistent trim appearance, regardless of variability in valve rough-in

Required Accessories

K-2972-KS 1/2" Thermostatic Mixing Valve

or

K-2974-K 1/2" Volume Control Valve

or

K-2975-KS 3/4" Thermostatic Mixing Valve

or

K-2976-KS 3/4" Thermostatic Mixer

or

K-2977-K 3/4" Volume Control Valve

or

K-728-K 3/4" Two- or Three-Way Transfer Valve

or

K-737-K 3/4" Two- or Three-Way Diverter Valve



ADA

Codes/Standards

ASME A112.18.1/CSA B125.1

ASSE 1016/ASME A112.1016/CSA B125.16

ADA

ICC/ANSI A117.1

KOHLER® Faucet Lifetime Limited Warranty

See website for detailed warranty information.

Available Color/Finishes

Color tiles intended for reference only.

Color	Code	Description
	CP	Polished Chrome
	TT	Titanium

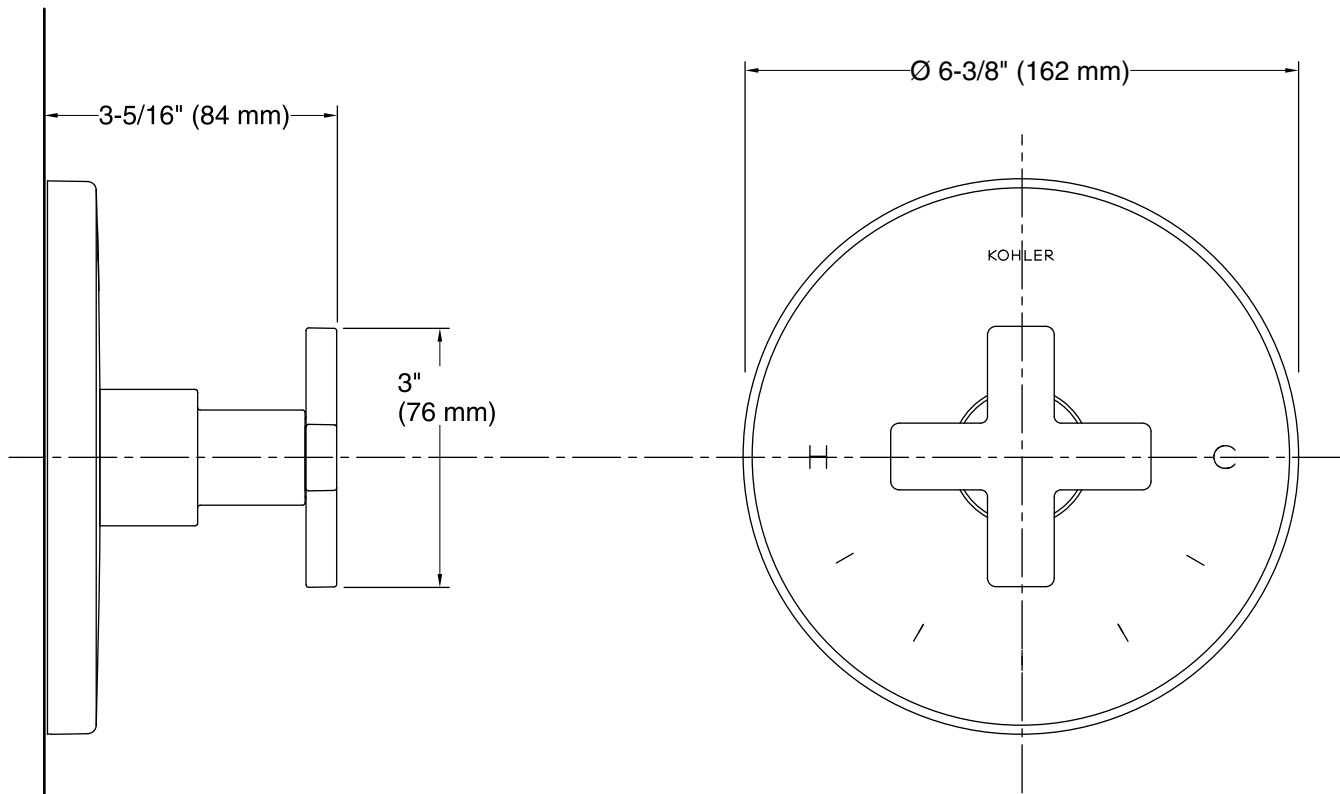

Technical Information

All product dimensions are nominal.

Notes

Install this product according to the installation guide.

ADA compliant when installed to the specific requirements of these regulations.