



**Soho®**  
Wall-Mount Bathroom Sink  
**K-2084-NL**

**Features**

- Single center hole.
- Soap dispenser hole on left.
- 20" (508 mm) x 18" (457 mm)

**Material**

- Vitreous china.

**Installation**

- Wall-mount.
- Drilled for concealed arm carrier.

**Recommended Accessories**

K-8998 P-Trap

**Components**

Additional included component/s: Hanger (2 Required).



ADA CSA B651 OBC

**Codes/Standards**

ASME A112.19.2/CSA B45.1  
ADA  
ICC/ANSI A117.1  
CSA B651  
OBC

**KOHLER® One-Year Limited Warranty**  
See website for detailed warranty information.

**Available Color/Finishes**

*Color tiles intended for reference only.*

Color	Code	Description
	0	White

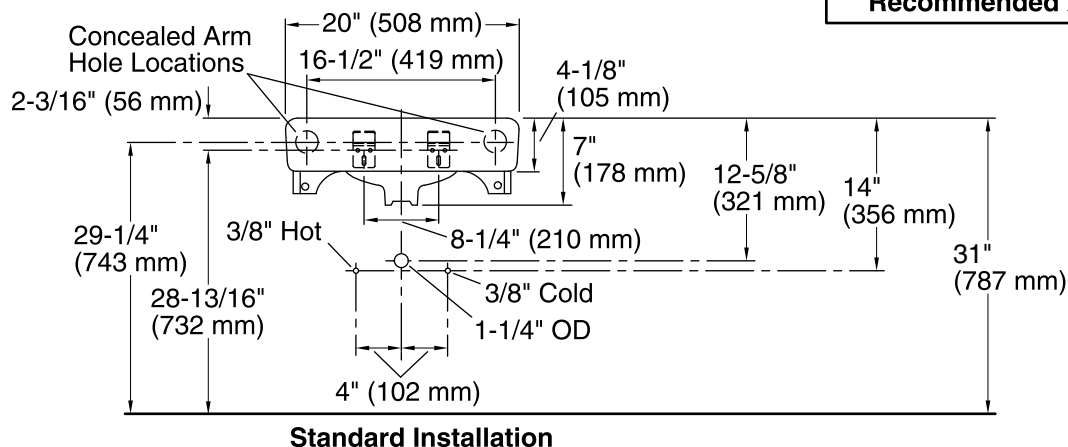
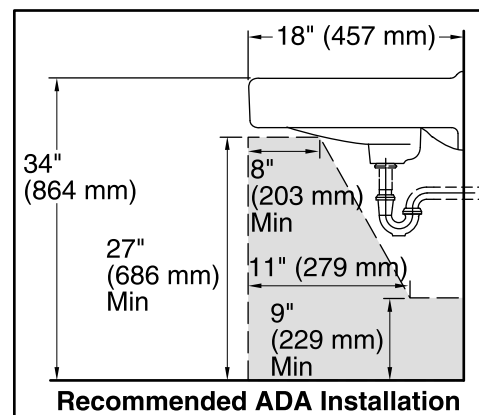
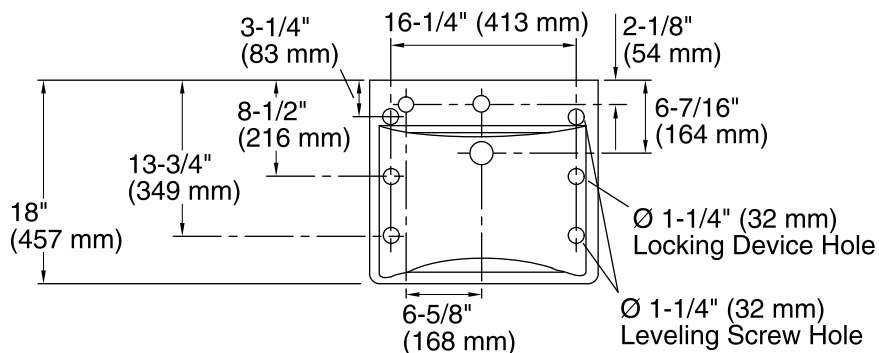

## Technical Information

All product dimensions are nominal.

Bowl configuration: Single

Installation: Wall-mount

Bowl area (Only) Length: 18" (457 mm)  
Width: 13" (330 mm)  
With overflow: Yes  
Water depth: 4-7/8" (124 mm)  
With overflow: Yes

Bowl area With overflow: Yes

Number of deck holes: 2

Faucet hole(s): 1-3/8" (35 mm)

Soap/Lotion hole: 1-1/4" (32 mm)

Drain hole: 1-3/4" (44 mm)

## Notes

Install this product according to the installation instructions.

If an arm carrier is used, select a soap dispenser with a 1" (25 mm) maximum shank diameter to avoid interference with the arm carrier.

Use a soap dispenser with adequate shank length to extend through the 4-1/8" (105 mm) sink thickness.

ADA, OBC, CSA B651 compliant when installed to the specific requirements of these regulations.