

### Features

- Activation distance is factory-set.
- Chloramine and chlorine resistance on all rubber components exposed to waterway.
- Engineered for optimal performance with KOHLER® commercial fixtures.
- 125-micron filter protects internal components.
- No external flush volume adjustment ensures water conservation.
- 24-hour automatic sentinel flush keeps trapway fresh.
- Mechanical override enables flushometer to be used manually even during a power outage.
- Powered by a 30 year/875,000 cycle hybrid energy cell.
- Less stop valve and tailpiece.

### Material

- Brass construction with durable Polished Chrome finish.

### Technology

- Flushometer activates when hand is waved over electronic infrared WAVE sensor.
- Patented piston technology for superior flush volume accuracy.

### Installation

- Intended for urinal installations with 3/4" (19 mm) top spud coupling connection.

### Recommended Products/Accessories

K-23723 Faucet cleaner

### Optional Products/Accessories

GP1118986 Flushometer Extension Kit

K-10313 Flushometer 12" rough-in kit



ADA

CSA B651

OBC

### Codes/Standards

ASME A112.18.1/CSA B125.1

ASSE 1037/ASME A112.1037/CSA B125.37

ADA

ICC/ANSI A117.1

CSA B651

OBC

### KOHLER® One-Year Limited Warranty

See website for detailed warranty information.

### Available Colors/Finishes

*Color tiles intended for reference only.*

#### Color Code Description



CP Polished Chrome

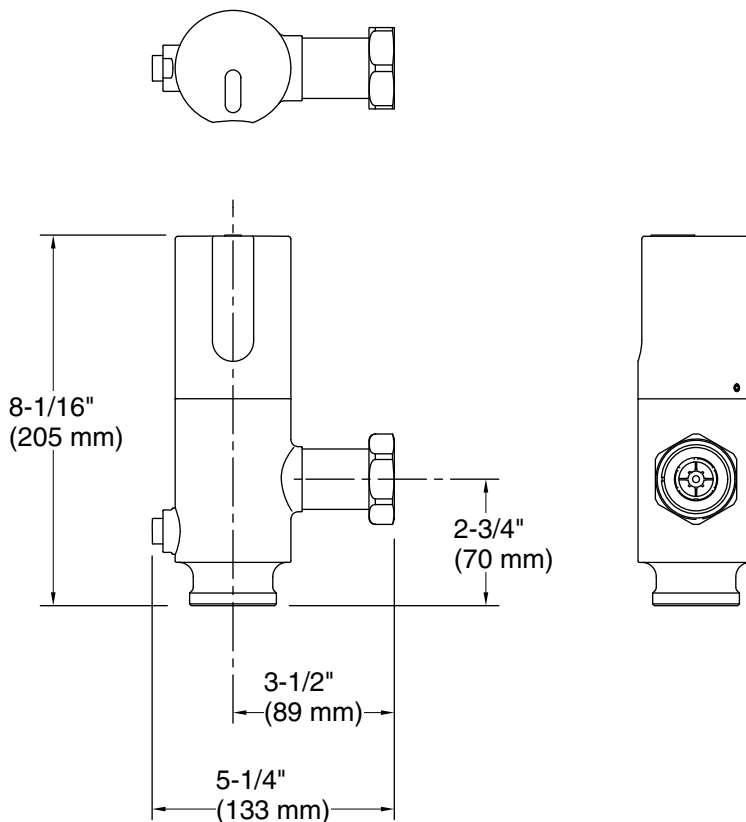

### Technical Information

All product dimensions are nominal.

Power source: Hybrid Energy Cell, not included

Drain included: No

### Pressure/fixture Supply Requirements

Fixture pressure 80 psi (551.6 kPa)  
max (static):

Fixture pressure min 25 psi (172.4 kPa)  
(static):

Min flowing 25 psi (172.4 kPa)  
pressure:

Min flow rate: 25 gpm (94.6 lpm)

### Notes

Install this product according to the installation instructions.

ADA, OBC, CSA B651 compliant when installed to the specific requirements of these regulations.