



Brenham™
Wall-Mount Bathroom Sink
K-1997-8N

Features

- With hanger.
- Without overflow.
- Drilled for concealed arm carrier.
- 8 " (203 mm) centers.
- 21-15/16 " (557 mm) x 19-3/4 " (502 mm)

Material

- Vitreous china.

Installation

- Wall-mount installation.

Optional Accessories

K-8998 P-Trap
K-1998 Shroud

Components

Additional included component/s: Hanger (2 required).



ADA

CSA B651

OBC

Codes/Standards

ASME A112.19.2/CSA B45.1
ADA
ICC/ANSI A117.1
CSA B651
OBC

See website for detailed warranty information.

Available Color/Finishes

Color tiles intended for reference only.

Color Code Description



0

White

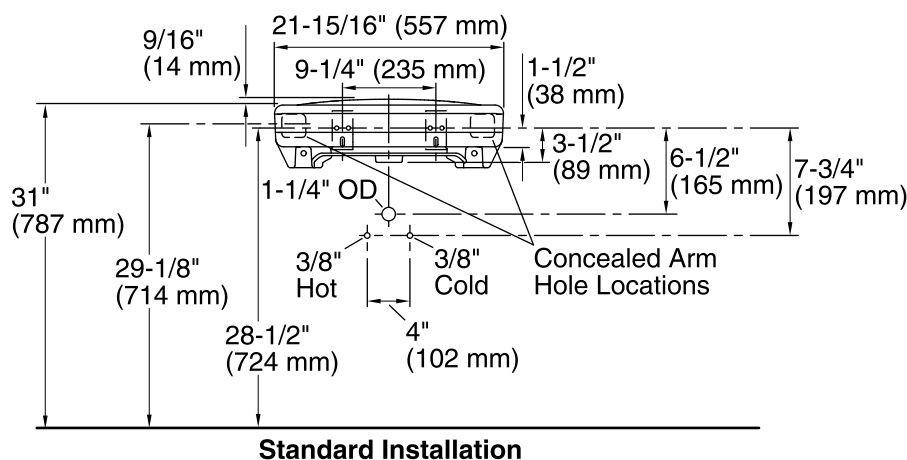
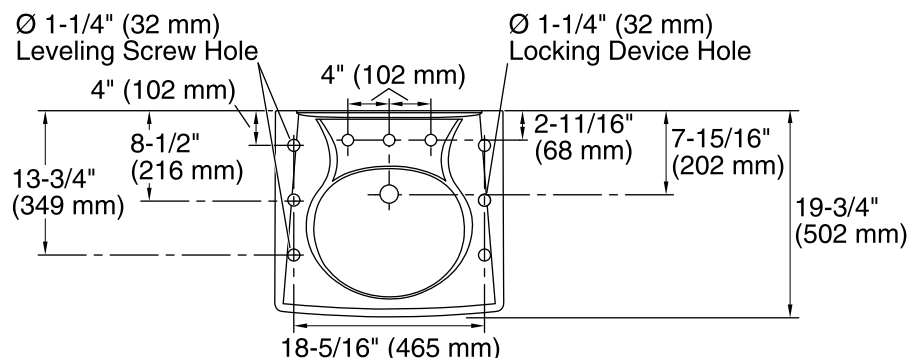

Standard Installation

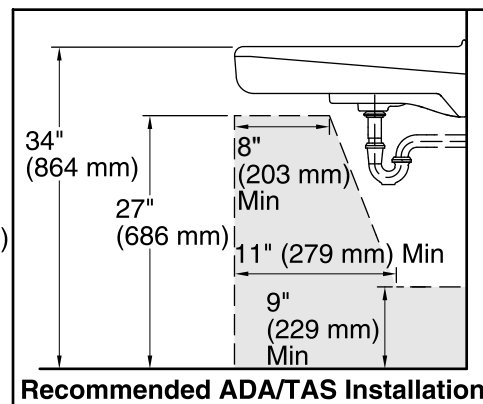

Recommended ADA/TAS Installation

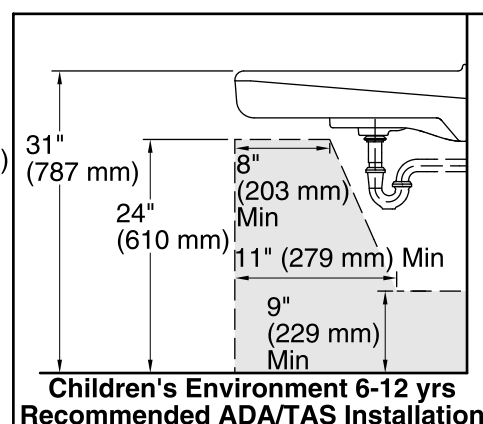

Children's Environment 6-12 yrs Recommended ADA/TAS Installation

Technical Information

All product dimensions are nominal.

Bowl configuration: Single

Installation: Wall-mount

Bowl area (Only) Length: $14\text{-}3/8"$ (365 mm)
Width: $12\text{-}5/16"$ (313 mm)
With overflow: Yes
Water depth: $3\text{-}1/4"$ (83 mm)

Bowl area With overflow: Yes

Number of deck holes: 3

Faucet hole(s): $1\text{-}3/8"$ (35 mm)

Drain hole: $1\text{-}3/4"$ (44 mm)

Notes

Install this product according to the installation instructions.

ADA, OBC, CSA B651 compliant when installed to the specific requirements of these regulations.