

Features

- 18 gauge stainless steel
- Undercounter
- Single compartment
- Rounded bowl(s)
- Includes installation hardware
- 17-7/8" (45.4 cm) x 17-7/8" (45.4 cm)

Codes/Standards Applicable

Specified model meets or exceeds the following:

- None applicable

UNDERCOUNTER SINK K-3335

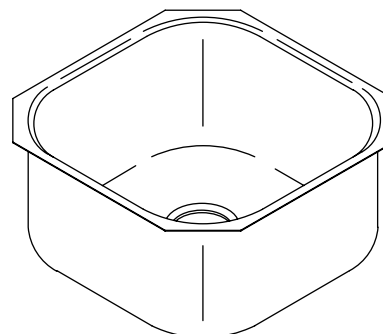

Colors/Finishes

- NA: None applicable

Accessories:

- CP: Polished Chrome
- 0: White
- NA: None applicable
- Other: Refer to Price Book for additional colors/finishes

Specified Model

Model	Description	Colors/Finishes	
K-3335	Undercounter sink	<input type="checkbox"/> NA	
Optional Accessories			
K-2989	Countertop cutting board	<input type="checkbox"/> NA	
K-3191	Bottom basin rack	<input type="checkbox"/> 0 White_____	<input type="checkbox"/> Other_____
K-3279	Wire rinse basket	<input type="checkbox"/> 0 White_____	<input type="checkbox"/> Other_____
K-8801	Duostrainer [®] sink strainer	<input type="checkbox"/> CP	<input type="checkbox"/> Other_____
K-8813	Stainless steel sink strainer with tailpiece	<input type="checkbox"/> CP	
K-8814	Stainless steel sink strainer less tailpiece	<input type="checkbox"/> CP	

Product Specification

The undercounter sink shall be 17-7/8" (45.4 cm) in length and 17-7/8" (45.4 cm) in width. Sink shall be made of 18 gauge stainless steel. Sink shall be single compartment with rounded bowl. Sink shall include installation hardware. Sink shall be Kohler Model K-3335.

UNDERTONE™

Technical Information

Fixture*:	
Basin area	17-7/8" (45.4 cm) x 17-7/8" (45.4 cm)
Water depth	9-1/2" (24.1 cm)
Drain hole	3-5/8" (9.2 cm) D.
*Approximate measurements for comparison only.	

Included components:	
Hardware kit	91915
Cut-out template	113196-7

Installation Notes

Install this product according to the installation guide.

Allow a minimum of 2" (5.1 cm) clearance around the sink rim for clip attachment.

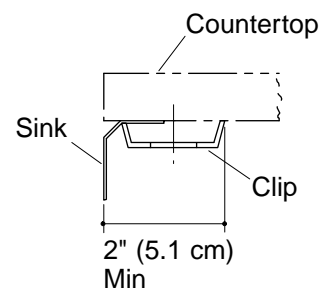
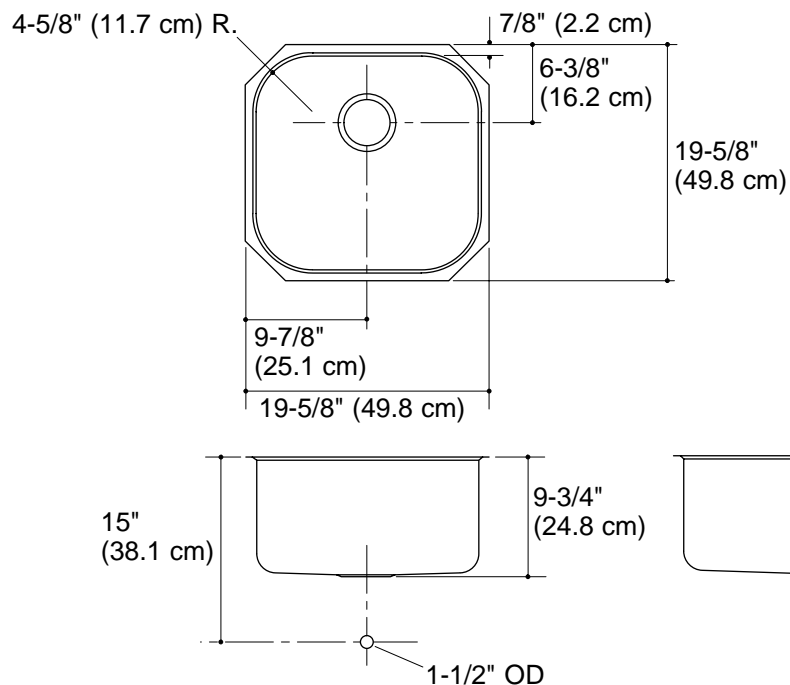

Product Diagram