

Features

- 18-gauge stainless steel
- Undercounter
- Single compartment
- Rounded bowl(s)
- Includes installation hardware
- 13-3/4" (34.9 cm) x 15-3/8" (39.1 cm)

UNDERCOUNTER SINK

K-3336
ALSO K-14300

Codes/Standards Applicable

Specified model meets or exceeds the following:

- ASME A112.19.3/CSA B45.4

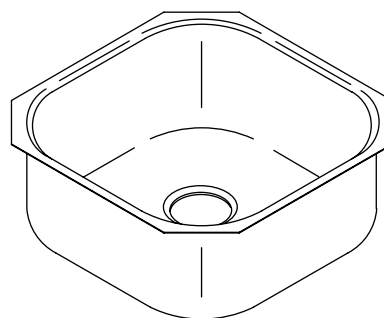

Colors/Finishes

- SBV: Satin Bronze
- NA: None applicable

Accessories

- 0: White
- CH: Chrome
- NA: None applicable
- Other: Refer to Price Book for additional colors/finishes

Specified Model

Model	Description	Colors/Finishes
K-3336	Undercounter sink – kitchen sink	<input type="checkbox"/> NA
K-14300	Undercounter sink – entertainment sink	<input type="checkbox"/> SBV

Optional Accessories					
K-3278	Hardwood cutting board	<input type="checkbox"/> NA			
K-3291	Colander	<input type="checkbox"/> 0			<input type="checkbox"/> Other_____
K-8801	Duostrainer® sink strainer		<input type="checkbox"/> CP		<input type="checkbox"/> Other_____

Product Specification

The undercounter sink shall be 13-3/4" (39.1 cm) in length and 15-3/8" (39.1 cm) in width. Sink shall be made of 18 gauge stainless steel. Sink shall be single compartment with rounded bowl. Sink shall include installation hardware. Sink shall be Kohler Model K-_____-_____.

UNDERTONE®

Technical Information

Fixture*:	
Basin area	13-3/4" (34.9 cm) x 15-3/8" (39.1 cm)
Water depth	7-1/2" (19.1 cm)
Drain hole	3-5/8" (9.2 cm) D.
*Approximate measurements for comparison only.	
Included components:	
Hardware kit	91915
Cut-out template	113197-7

Installation Notes

Install this product according to the installation guide.

Allow a minimum of 2" (5.1 cm) clearance around the sink rim for clip attachment.

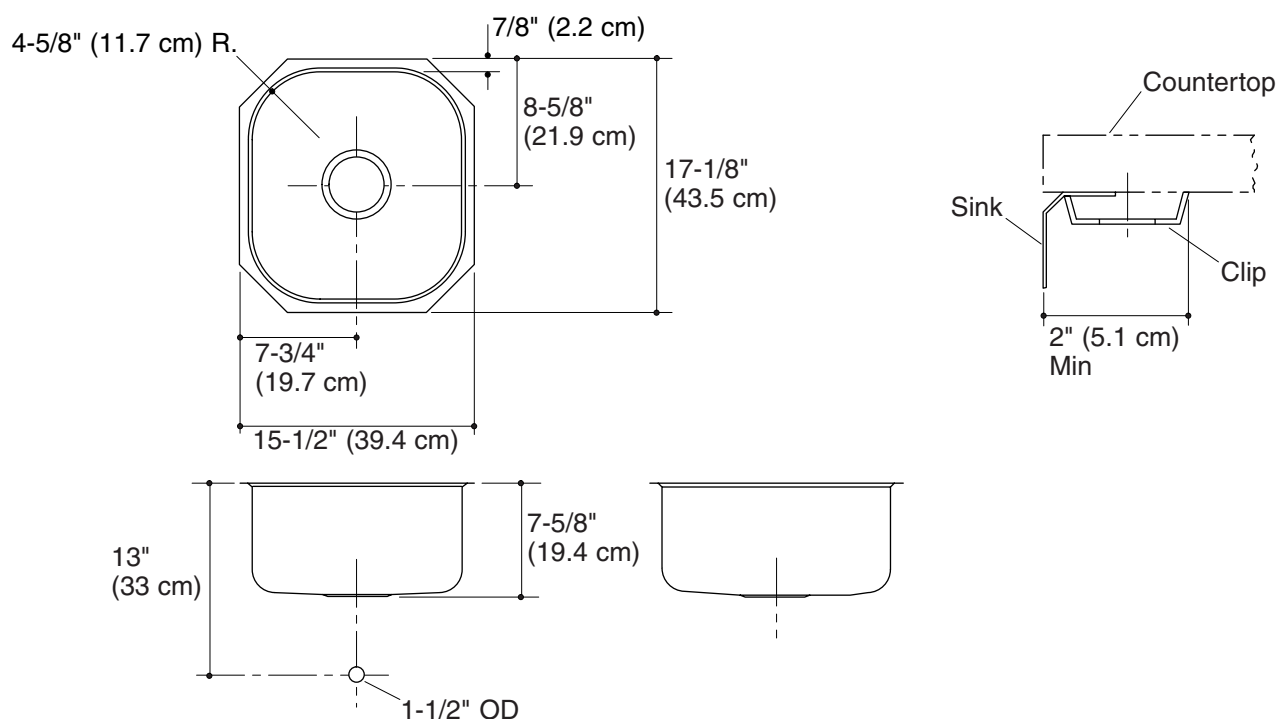

Product Diagram