



# Charlemont™

## 30" bathroom vanity cabinet with sink and quartz top

### K-29260-BD1

#### Features

- Set includes cabinet, precut quartz vanity top, backsplash, sink, cabinet hardware
- Convenient tilt-down drawer for storing smaller, frequently-used items
- Three-way adjustable slow-close door hinges for easy cabinet access
- 20" (508 mm) cabinet interior provides ample storage space
- Finish-matched cabinet interior offers generous clearance for plumbing
- Vanity top has 8" (203 mm) widespread faucet holes; requires deck-mount faucet (sold separately)
- Vibrant® Brushed Nickel hardware included on White vanities, Vibrant Brushed Moderne Brass hardware on Ferrous Grey and Tidal Blue vanities, and Matte Black hardware on Light Oak vanities
- White quartz (GWT) vanity top and backsplash add beauty and long-lasting durability

#### Material

- Vitreous china sink
- Solid wood and moisture-resistant MDF

#### Installation

- Separate vanity top makes for simplified installation
- Easy installation – no special tools required



#### Codes/Standards

ASME A112.19.2/CSA B45.1

#### KOHLER® One-Year Limited Warranty

See website for detailed warranty information.

#### Available Colors/Finishes

*Color tiles intended for reference only.*

Color	Code	Description
	0	White
	DWG	Ferrous Grey
	TDB	Tidal Blue
	WEK	Light Oak



**Charlemont™**  
30" bathroom vanity cabinet with sink and quartz top  
**K-29260-BD1**

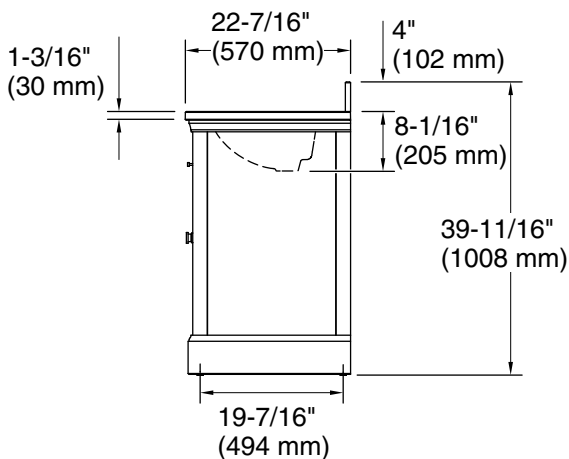
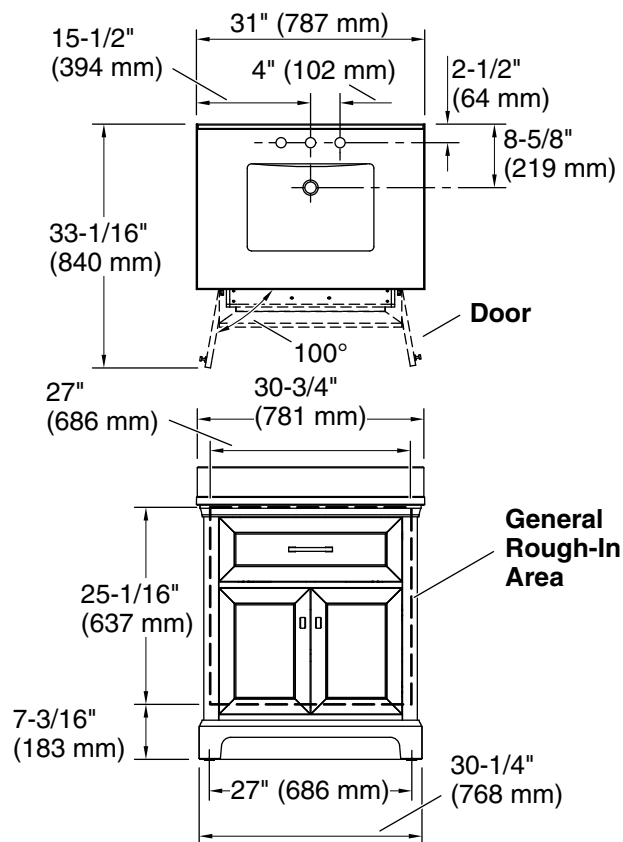

**Technical Information**

All product dimensions are nominal.

Lighting included: No

**Notes**

Install this product according to the installation instructions.

Select the type of fastener based upon the wall material. Two 250 lb (113.4 kg) minimum load bearing fasteners are recommended.