

### Ultra MEDICINE CABINET

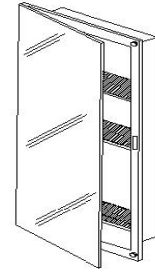

#### FEATURES/TYPICAL SPECIFICATIONS

- Recessed mount installation
  - Wall Opening/Rough-in dimensions: 14" x 24" x 4"
- Formed and welded flush design steel housing (WB/ST)
  - 24 gauge steel with white, heat cured, acrylic paint finish
- Frameless mirror door
  - 1/8" thick float glass mirror front with polished edges, 4 sides
  - 25 gauge steel door back with white, heat cured, acrylic paint finish
- 90° concealed hinge riveted to the door back and mechanically fastened to the cabinet body (HG05) (2 typical)
- Spring-loaded, magnetic touch latch fastened on cabinet body aligns to a stainless steel striker plate on the door back (1 typical)
- Reversible for left-hand or right-hand swing
- 5/32" thick float glass shelves, adjustable, (ADJ) (3 typical)
- Includes installation hardware
- Pallet quantity = 42

#### Finishes:

Housing: PT01—Basic White  
 Mirror: POL1—Polished Edge  
 Frame: Frameless

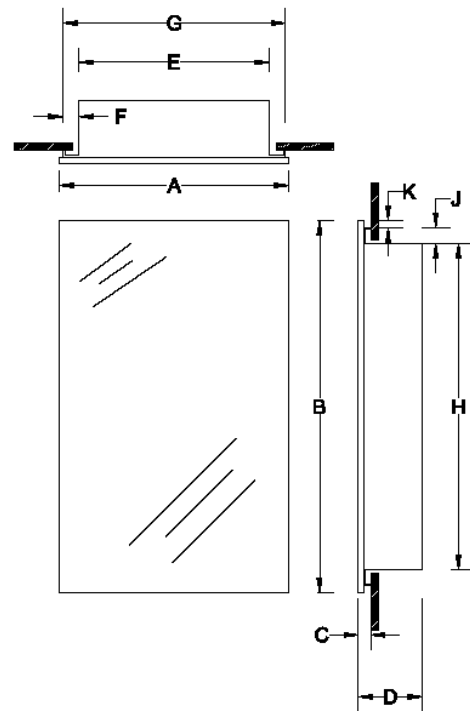

		Dimensions In Inches										
Model #	Description	A	B	C	D	E	F	G	H	J	K	
869P24WHG	MEDCAB 1DR 15X26 FMLS WB/ST	15	26	1/2	4 1/2	13 1/2	5/8	14 3/4	23 1/2	5/8	5/8	

REFERENCE	QTY.	REMARKS	Project
			Location
			Architect
			Engineer
			Contractor
			Submitted by
			Date

\* All models and material specifications are subject to change or withdrawal without notice.