

## Features

- Solid brass construction
- Single -post, double light design
- UL listed for damp locations
- ADA compliant
- May be installed vertically or horizontally
- Complements Surface product series

## Codes / Standards Compliance

Meets or exceeds the following at date of manufacture:  
All applicable US Federal and State material regulations

- UL 1598
- ADA
- All applicable US Federal and State material regulations

## Colors / Finishes

- PC: Polished Chrome
- SN: Satin Nickel
- Other: NA

*\*Installation Note (Electrician/Wall-finisher): This light uses a non-standard size backplate. This light is designed to be installed onto a standard switch box as follows: (1) vertically installed for a vertical light orientation and (2) horizontally for a horizontal light orientation. Maximum width (vertical) or height (horizontal) of finished opening is 2-1/2".*

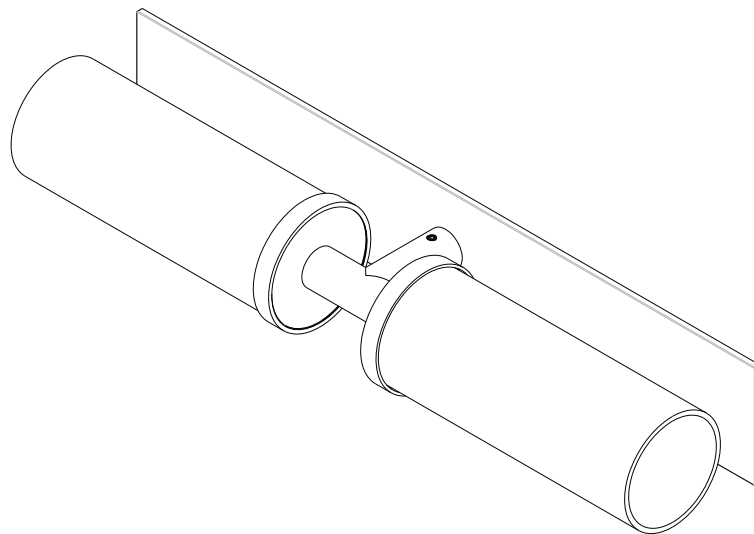

## Specified Model

Model	Description	Colors   Finishes	
2882	Double Light, Satin Etched Cased Opal*	<input type="checkbox"/> PC	<input type="checkbox"/> SN
3681-G-O	Replacement Glass Shade, Satin-Etched Cased Opal Glass		

## Product Specification:

Add "Color / Finish" Suffix to Model Number Below

The Double Light shall incorporate solid brass construction and a satin-etched cased opal glass shade. Double Light shall complement Ginger Surface product series. Double Light shall be Ginger Model 2882/\_\_\_\_\_.

# 2882

## Product Dimensions *(units are in inches)*

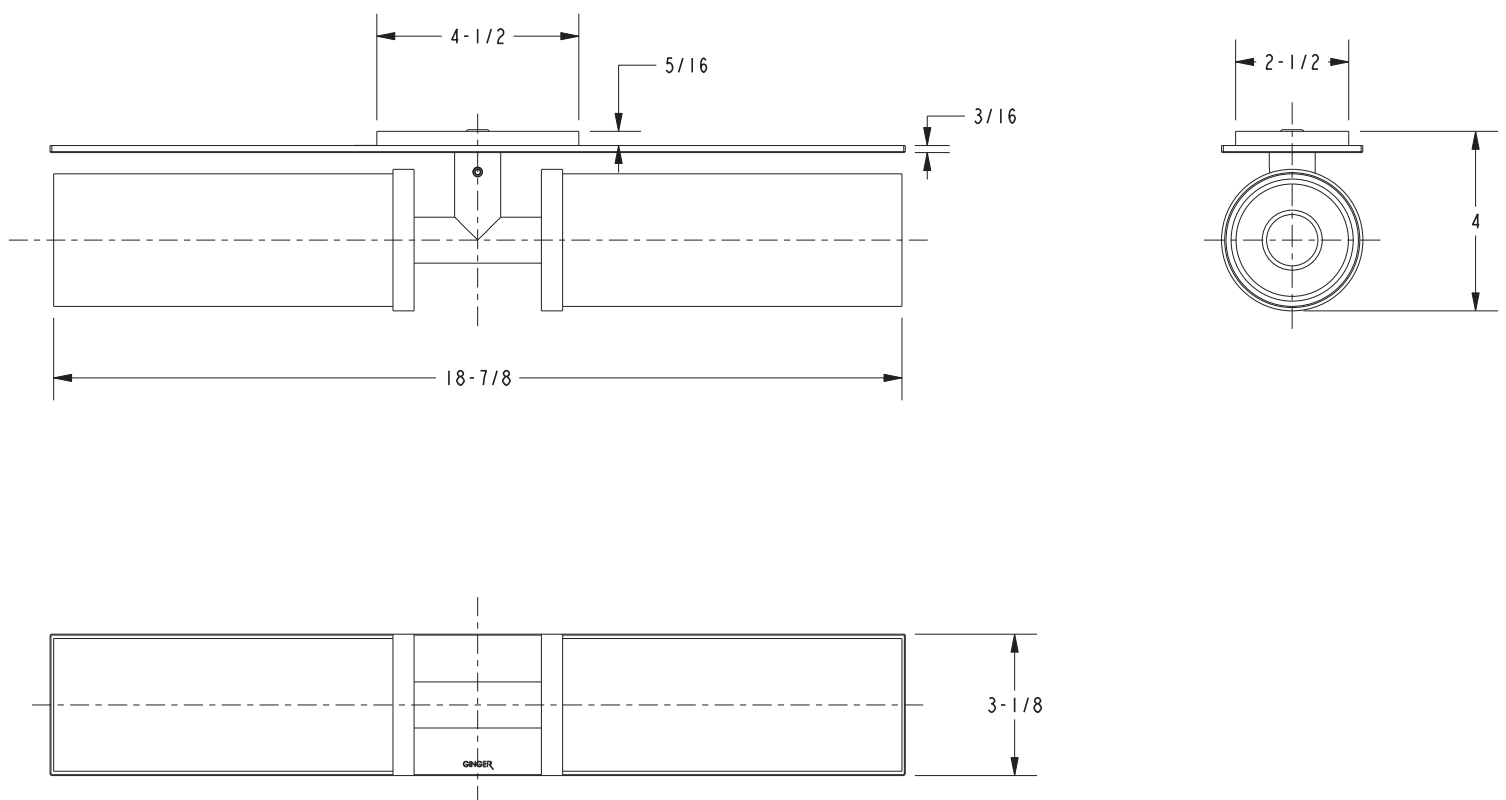

ADA compliant 