

- ASSEMBLY NOTES:
- 1.USE PERMANENT THREADLOCKER (LOCTITE 262 OR EQUIVALENT) ON ITEMS 3, 5 AND 6.
 - 2. SILVER SOLDER ASSEMBLED JOINTS AND POLISH SMOOTH.
 - 3. DURING FINAL ASSEMBLY: APPLY THIN LAYER OF (LOCTITE 404) AFTER O-RINGS ARE INSTALLED AND JUST BEFORE THE BAR.

BILL OF MATERIAL					
ITEM	PT/ASSY	DESCRIPTION	TYPE	QTY.	DWG.NO.
1	454B	MOUNTING FLANGE	PART	2	HTL-049
2	4500	ROSETTE	PART	2	45A-003
3	4540SP	HOTEL SHELF POST	PART	2	HTL-050
4	4540LP	HOTEL SHELF POST (LONG)	PART	2	HTL-052
5	4550F	POST FLANGE	PART	4	45A-005
6	4540-43ADP	THREAD EXTENSION	PART	2	HTL-051
7	SM5-5S	M5 x5 STAINLESS STEEL SET SCREW	PART	2	-
8	454024	SIDE TUBE	PART	2	HTL-053
9	45408	CROSS TUBE	PART	11	HTL-054
10	10_1-5_PFS	No. 10 x 1-1/2" P H S.S. SELF TAPPING	PART	6	-
11	GCA	NO. 8 -10 WALL ANCHOR PLASTIC	PART	6	-
12	RM16-1	16mm x 1mm BUNA-N- O-RING	PART	4	-
13	M2_5HK	2.5MM ALLOY STEEL HEX KEY	PART	1	-
14	SSPM	DRYWALL ANCHOR	PART	6	-

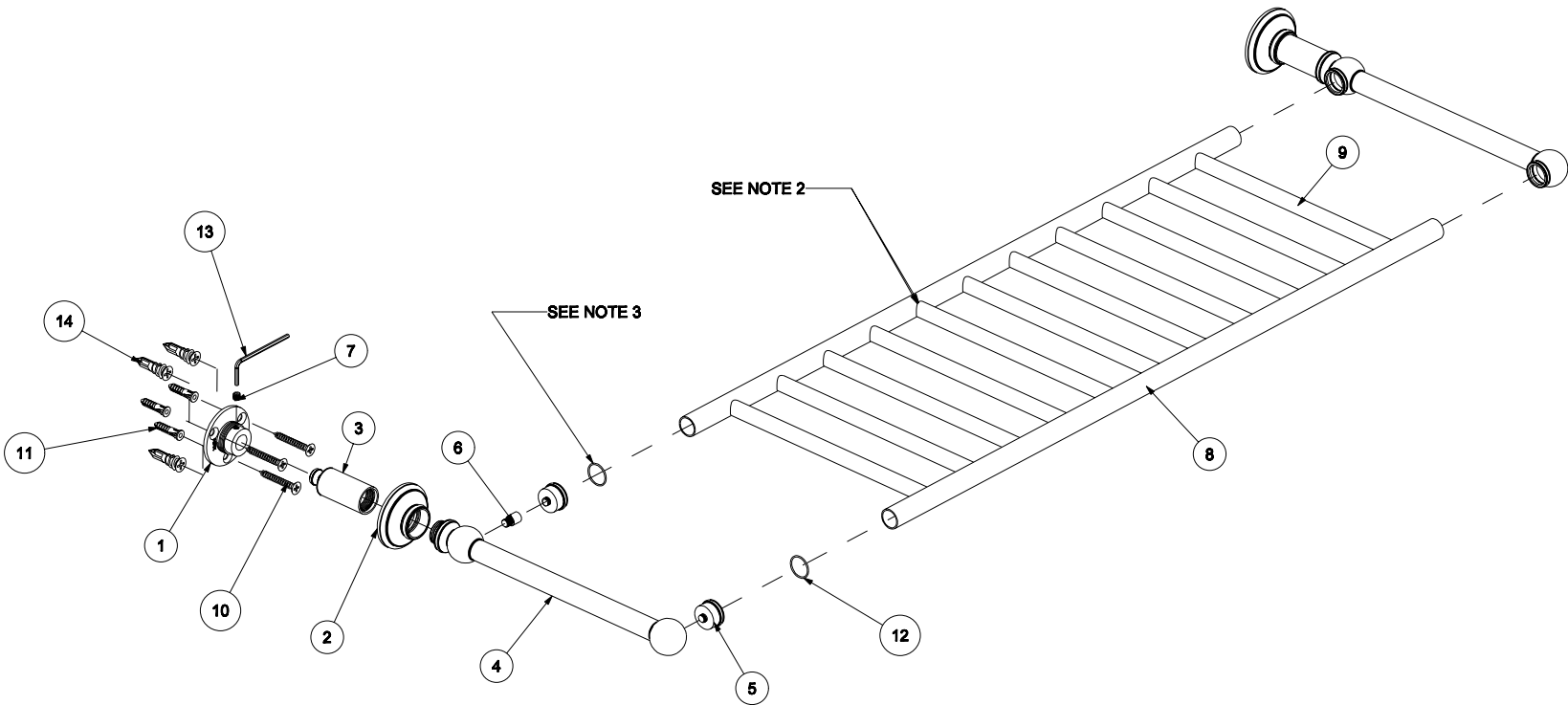

FINISHES:AGD- ANTIQUE GOLD, AS- ANTIQUE SILVER, 10B- OIL RUBBED BRONZE,14- POLISHED NICKEL, 15- SATIN NICKEL, 26 POLISHED CHROME						GINGER DWG.NO. 4540-24
MATERIAL: VARIOUS BRASSES AND STAINLESS STEEL MOUNTING HARDWARE						
PART NO. 4540-24		24" COLUMNAR HOTEL SHELF				
DATE:11.27.06	REV.DATE: 4.3.07	REV.B	SCALE 3:16	COLUMNAR		

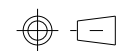
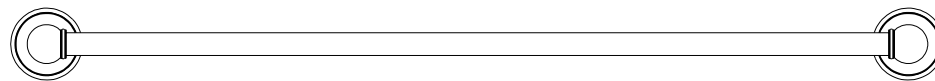
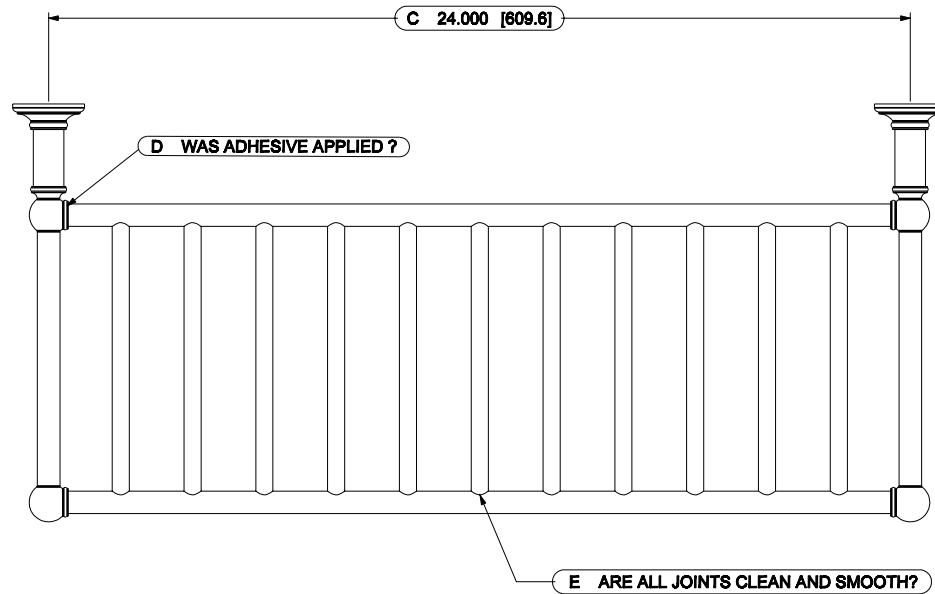
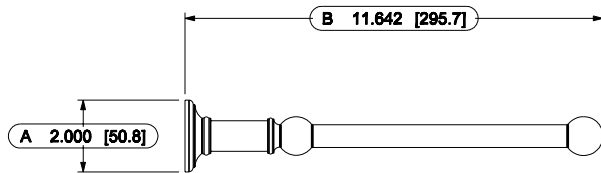

FINISHES:AGD- ANTIQUE GOLD, AS- ANTIQUE SILVER, 10B- OIL RUBBED BRONZE,14- POLISHED NICKEL, 15- SATIN NICKEL, 26 POLISHED CHROME					GINGER DWG.NO 4540-24
MATERIAL: VARIOUS BRASSES AND STAINLESS STEEL MOUNTING HARDWARE					
PART NO.	4540-24	24" COLUMNAR HOTEL SHELF			
DATE:11.27.06	REV.DATE: 4.3.07	REV.B	SCALE 3:16	COLUMNAR	