

DuraSquare Furniture handrinse basin # 0732450041 / 0732450070

< 17 3/4" Inch >

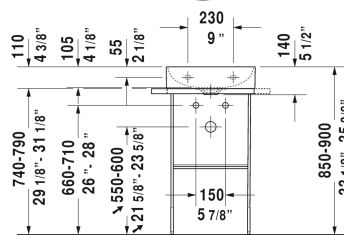
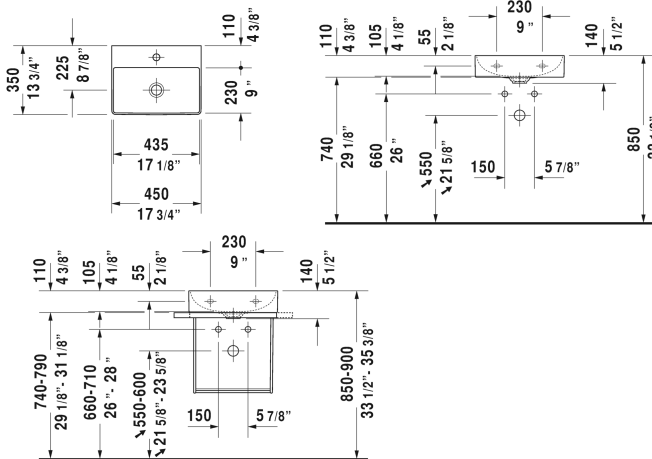

Furniture handrinse basin	Dimension	Weight	Order number
without overflow, with faucet deck, ceramic covered slotted waste included, underside fully glazed, hardware included, wall-mounted, 17 3/4" Inch			
Colors			
00 White			
Variant			
●	17 3/4" x 13 3/4" Inch	21.8 lb	0732450041
☒	17 3/4" x 13 3/4" Inch	21.8 lb	0732450070
Infobox			
Metal console: Towel rail can be mounted right or left , Made of DuraCeram, For glass inserts matching to furniture lacquer finishes, please see page XXX			
Sanitary ceramics with the special WonderGliss surface finish will remain clean and attractive-looking for a long time to come. When ordering WonderGliss please add a "1" as eleventh digit to the model number.			
Suitable products			
Metal console floorstanding ** height adjustable +2", hardware included, for handrinse basin # 073245, towel rail right or left, reversible, 20 1/4" x 13 1/8" Inch	20 1/4" x 13 1/8" Inch		003109
Metal console wall-mounted ** hardware included, for handrinse basin # 073245, towel rail right or left, reversible, 20 1/4" x 13 1/8" Inch	20 1/4" x 13 1/8" Inch		003110

**DuraSquare Furniture handrinse basin # 0732450041 /
0732450070**

|< 17 3/4" Inch >|

Glass inserts safety glass, for metal console # 003109, 003110, 16 1/2" x 10 3/8" Inch	16 1/2" x 10 3/8" Inch	009966
Vanity unit wall-mounted 1 door, for DuraSquare # 073245, 17 1/8" x 13 3/8" Inch	17 1/8" x 13 3/8" Inch	XS4060 L/R
Vanity unit floorstanding 1 door, 1 glass shelf, integrated legs with height adjustment, for DuraSquare # 073245, 17 1/8" x 13 3/8" Inch	17 1/8" x 13 3/8" Inch	XS4441 L/R

All drawings contain the necessary measurements which are subject to standard tolerances. They are stated in inch & mm and are non-binding. Exact measurements, in particular for customized installation scenarios, can only be taken from the finished ceramic piece.