

Wallmount Service Sink Faucets Rigid Spout

TECK®
COMMERCIAL

DELTA®

Specification: (example)

- **HEAVY-DUTY CAST BRASS** two handle wallmount service sink faucet
 - 203mm (8") centers, polished chrome plated finish
 - Integral check stops
 - **HEAVY DUTY 1/2" IPS BRASS PIPE** rigid pail hook spout
 - ADA compliant color indexed metal lever or blade handles with vandal resistant screws
 - **CER-TECK®** 1/4 turn ceramic structures
- and ... with ... (add spout/brace required)
 with ... (add outlet/VB required)
 with ... (add handle required)
 with ... adjustable centers
 (add Suffix **AC** if required – See Back Page)

28C2384



28C2383



Engineer/Architect Approval











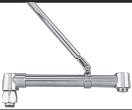

Model Specified:

Approval:

Date:

DESCRIPTION	PRODUCT NO.
Two Handle Wallmount With Integral Check Stops	28C2



SPOUT/BRACE	OUTLET/VB	HANDLE
0 140mm (5 1/2") Plain Spout, Less Brace (1)  <input type="checkbox"/>	0 <input type="checkbox"/>	0 <input type="checkbox"/>
1 <input type="checkbox"/>	1 Body Mounted Double-Check Vacuum Breaker, Hose Thread Outlet (2)  <input type="checkbox"/>	1 <input type="checkbox"/>
2 <input type="checkbox"/>	2 <input type="checkbox"/>	2 <input type="checkbox"/>
3 267mm (10 1/2") Spout with Adjustable Top/Bottom Brace (1)  <input type="checkbox"/>	3 <input type="checkbox"/>	3 76mm (3") Lever Blade Handles  <input type="checkbox"/> 
4 <input type="checkbox"/>	4 <input type="checkbox"/>	4 102mm (4") Blade Handles, Sanitary Hoods  <input type="checkbox"/> 
5 <input type="checkbox"/>	5 <input type="checkbox"/>	5 152mm (6") Wrist Handles, Sanitary Hoods  <input type="checkbox"/> 
6 <input type="checkbox"/>	6 Spout End Vacuum Breaker, Hose Thread Outlet  <input type="checkbox"/>	6 <input type="checkbox"/>
7 <input type="checkbox"/>	7 <input type="checkbox"/>	7 <input type="checkbox"/>
8 <input type="checkbox"/>	8 Body Mounted Angle Vacuum Breaker, Hose Thread Outlet  <input type="checkbox"/>	8 <input type="checkbox"/>
9 406mm (16") Spout with Bottom Fork Brace (1) (3)  <input type="checkbox"/>	9 <input type="checkbox"/>	9 <input type="checkbox"/>

(1) Distance from wall to Spout Outlet based on #6 Outlet. (2) Recommended for applications with a shut-off valve after Spout Outlet.
 (3) AC Suffix **not** available with #9 Spout/Brace Option.

Flow Rates are at 60 PSI.
 Refer to www.specselect.com for individual models.
 Note: Use this page front and back as a product submittal sheet.

Approvals:

- CSA certified
- Complies to ASME A112.18.1/CSA B125.1
- Handles No. 3, 4, and 5
Indicates compliance to ICC/ANSI A117.1

OUTLET/VACUUM BREAKERS:

- No. 1 Certified under CSA Standard B64.8
- No. 6 Certified under ASSE 1011 and CSA Standard B64.2
- No. 8 Certified under ASSE 1001 and CSA Standard B64.1.1

(Contact Delta Representative for State and/or Local Approvals.)

Not for potable water.

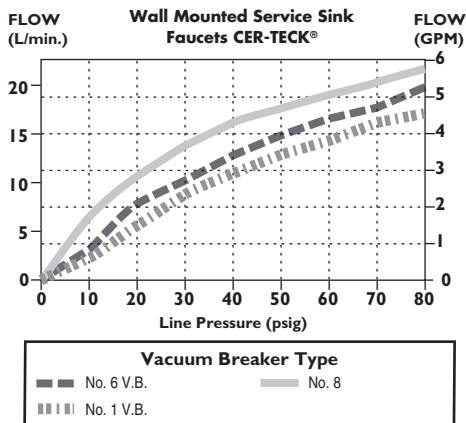
FLOW RATE vs PRESSURE

**Available Option
for Field Conversion**

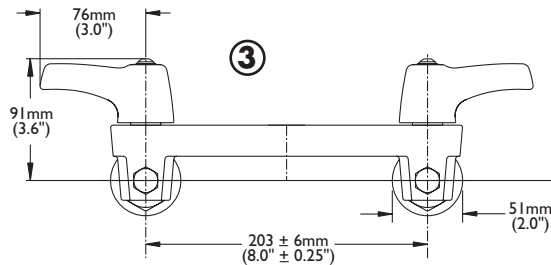
- 28T911**
Hose and Hanger
See **DSP-28T9** for detailed specification

WALLMOUNT FAUCET

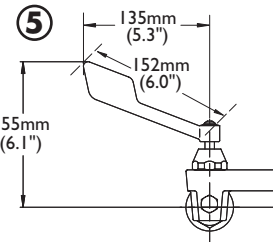
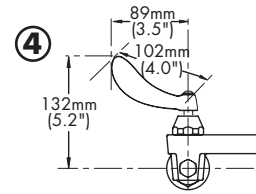
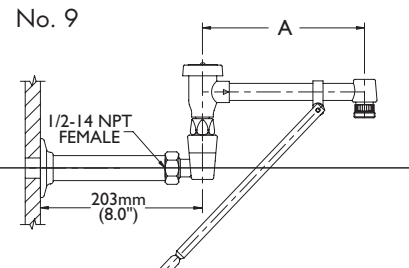
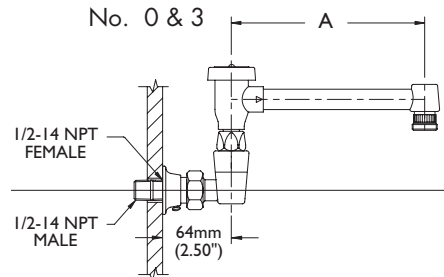
INLETS: 1/2-14 NPT (FEMALE)
OR 1/2-14 NPT (MALE) – WITH SUPPLIED NIPPLE

SPOUT/BRACE

ADJUSTABLE CENTERS

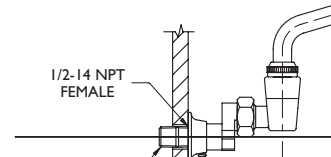
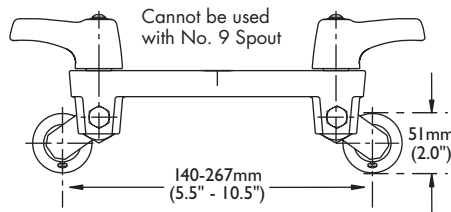
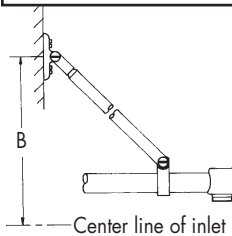
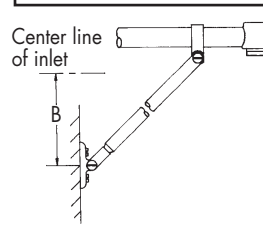
- Add Suffix "AC" to Product Number

TOP BRACE

BOTTOM BRACE

BRACES

Two
No. 8 x 1"
Pan Head
Screws
Supplied

29mm
(1.13")

Four
No. 8 x 1"
Pan Head
Screws
Supplied

29mm
(1.13")
114mm
(4.5")

RIGID SPOUT ASSEMBLIES

SPOUT DIMENSIONS	Outlet/VB - "A"					
	#1		#6		#8	
	mm	in.	mm	in.	mm	in.
Spout/Brace #0 less -AC	104	4.1	81	3.2	86	3.4
Spout/Brace #3 less -AC	211	8.3	203	8.0	208	8.2
Spout/Brace #9 less -AC	211	8.3	203	8.0	208	8.2
Spout/Brace #0 with -AC	104	4.1	81	3.2	86	3.4
Spout/Brace #3 with -AC	211	8.3	203	8.0	208	8.2
Spout/Brace #9 with -AC	#9 spout/brace not available with - AC suffix					

Brace Rough-in dimensions
based on #8 Outlet/VB

INLETS - 1/2" FIP/MIP on
Spouts # 0 & 3

INLETS - 1/2" FIP on Spout # 9

Note: Measurements may vary ± 6mm (0.25")

Refer to www.specselect.com for individual models.

Note: Use this page front and back as a product submittal sheet.