

# American Standard

---

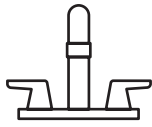

---

**American Standard is devoted to making life,  
in the heart of your home, better every day...**

...so, thank you for inviting us in! With the very best in kitchen and bathroom products, we are here to help make your life happier, healthier and simpler. Our commitment to quality, innovation and performance has made us part of your everyday routine for nearly 150 years, and we look forward to being a part of your life for many years to come.

**Learn more at [www.AmericanStandard.com](http://www.AmericanStandard.com)**

## **REGISTER YOUR WARRANTY**

Try the easy-scan **QR code** to quickly enter your information or find your product's detailed warranty here:

**[www.AmericanStandard.com/warranty](http://www.AmericanStandard.com/warranty)**



Registering allows you to keep your product information safe, and us the ability to contact you in the event of a product recall or *any* news about your purchase.

**And if ever you have a question or need help...?**

Call us at 1-855-815-0004

# OWNERS MANUAL

## Princeton Pro Direct to Stud Tile Walls™ 3-piece Wall Sets

3961BWT60.020, 3961SWT60.020, 3962SWT60.020,  
3962BWT60.020, 3963SWT48.020, 3963SWT60.020.

### INSTALLATION INSTRUCTIONS

Thank you for selecting American Standard – the benchmark of fine quality for over 150 years. To ensure this product is installed properly, please read these instructions carefully before you begin. Certain installations may require professional help.

#### INSTALLATION PREPARATION

- Please unpack carefully and identify all parts needed for installation by using the Box Contents as a reference. Inspect the product and report any damages or missing parts immediately to customer care by calling 855-815-0004. Follow the prompts for consumer/bathing products.

**NOTE:** Take extra care in handling the front surfaces of the walls. Use only non-abrasive cloths to avoid scratching.

- These Princeton Pro Direct to Stud Tile Walls were developed to be installed with Princeton Tubs and Shower Bases.. If you are using a different tub or shower base, you may need additional hardware and tools to complete the installation.
- The Princeton Pro Direct to Stud Tile Wall dimensions are nominal and meant for standard 60x30"x60 (1524x762x1524mm) 60x30x72 (1524x762x1829mm), 60x32x72 (1524x813x1829mm), 60x32x60 (1524x813x1524mm) 60x36x72 (1524x915x1829mm) and 48x36x72 (1219x915x1829mm) alcoves. Alcove sizes may vary based on stud and wall material thickness. Please double check your measurements prior to starting your install.
- Wear protective equipment during installation to avoid injury.
- Please keep these instructions for after care and customer service details.

**NOTE: Do not add Tub Clips on REAR Required Studs when installing Princeton Pro Wall system!**

- Provide additional wall support using 1x4" keeping it 1-1/4" (31.8mm) off the deck of a tub or shower base and screw into alcove framing.



#### BEFORE YOU BEGIN

Inspect your product thoroughly before installing. Take extra care in handling surfaces of the walls and use only non-abrasive cloths to avoid scratching. Observe all local plumbing and building codes.

## RECOMMENDED TOOLS AND MATERIALS

Installation steps will indicate which tools should be used with associated letter



Level

**A**



Tape Measure

**B**

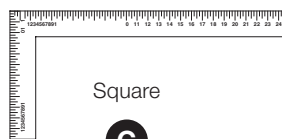

Square

**C**

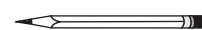

Pencil

**D**



Painter's  
Masking Tape

**E**



Caulking Gun

**F**

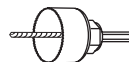

Hole Saw

**G**



Safety  
Equipment

**H**



Jig Saw with fine  
tooth blade

**I**

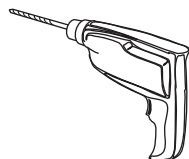

Drill

**J**

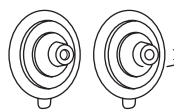

Suction Cups - optional

**K**



11/64" Drill Bit

**L**

### SOLD SEPARATELY

x6 Tubes Construction Adhesive. **NOTE:** Construction adhesive should be recommended for plastics AND NOT WATER CLEAN UP BEFORE CURING. Preferred adhesives of Loctite Brands: PL8X Premium, PL3X Premium, PL MAX Premium. Gorilla Heavy Duty Construction Adhesive  
x2 Tubes Tub & Tile Sealant  
#8 sharp point lath screw x1" long or longer  
x2 1x4"s

## INSTALLATION INSTRUCTIONS

### IMPORTANT GENERAL INFORMATION

This unit is best installed by two people.

Cover drain with tape prior to installation to prevent the loss of small parts.

Unpack your unit carefully and inspect for freight damage. Lay out and identify all parts using Box Contents as a reference. Before discarding the carton check to see that no small hardware parts have fallen to the bottom of the box. If any parts are damaged or missing refer to the description noted in the instructions when inquiring about replacements.

Be sure to wear safety glasses whenever drilling or cutting. When drilling holes in ceramic tile or marble use a center punch and hammer to carefully break the glazed surface. This will prevent skidding when drilling.

### BOX CONTENTS

1 Left Side Panel

1 Right Side Panel

1 Rear Wall Panel

2 Extruded Wall Connectors

*American Standard*

## ALCOVE STUD INSTALLATION

**NOTE:** Shower walls must be installed over a combination of required studs

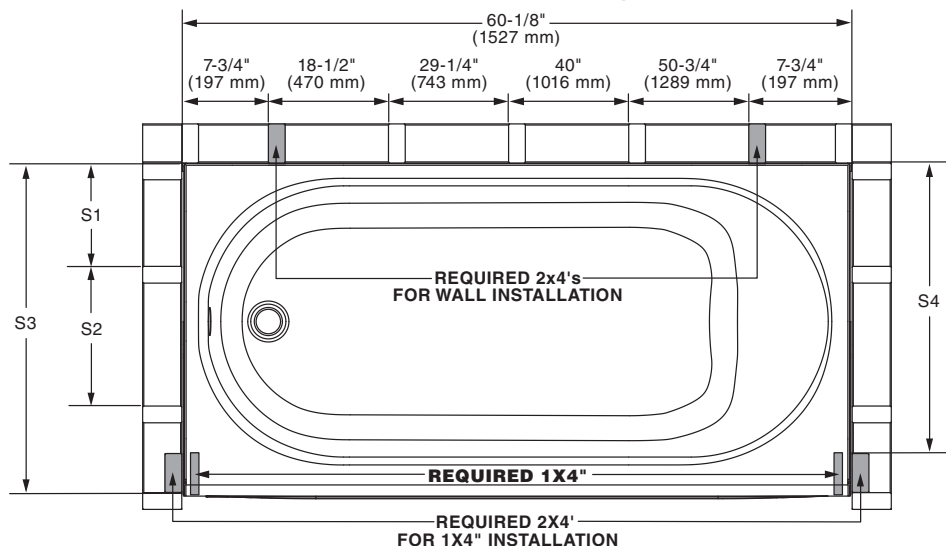

### Alcove Stud Installation for 60x30" & 60x32" tub or 60x30", 60x32", 60x36" shower bases.

Refer to Alcove Stud Installation illustration above for recommended 2x4 and 1x4 location.

**Shaded 1x4 and 2x4's are required to be precisely located as shown. Do not install tub clips or adhesive on Required 2x4's!!!!**

Ensure all studs are level and plumb. Fir-out studding if necessary.

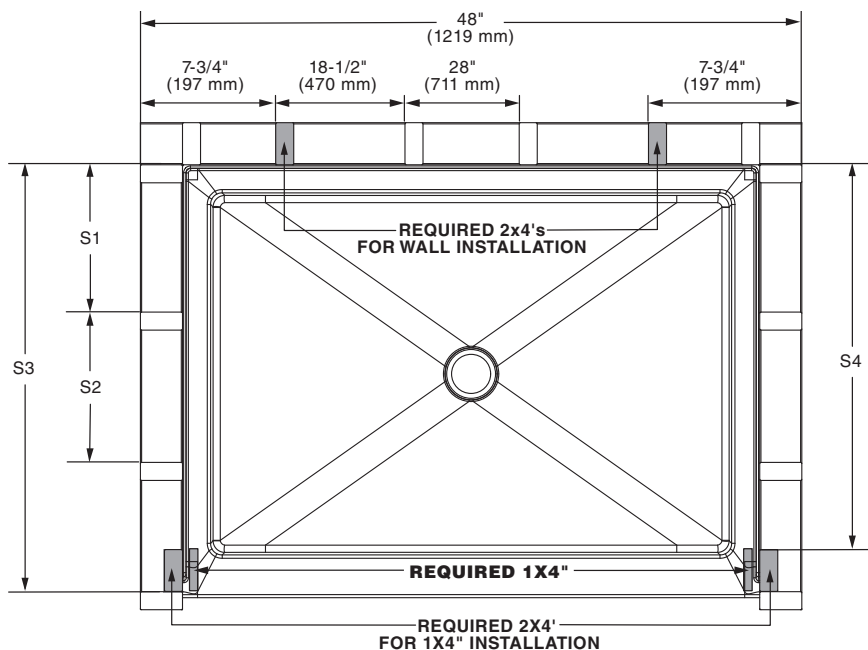

Alcove Opening (Model)	S1	S2	S3	S4
60x30	9-1/4" (235 mm)	21-3/4" (552 mm)	29-1/2" (749 mm)	26-3/16" (665mm)
60x32	10-1/4" (260 mm)	22-3/4" (578 mm)	31-1/2" (800 mm)	28" (711mm)
48x36	12-1/4" (311.2 mm)	24-3/4" (628.7 mm)	35-1/2" (901.7 mm)	32" (813mm)
60x36	12-1/4" (311.2 mm)	24-3/4" (628.7 mm)	35-1/2" (901.7 mm)	32" (813mm)

## REQUIRED 1X4 INSTALLATION

FOR 30" & 32" TUBS AND 30", 32" & 36 SHOWER BASES.

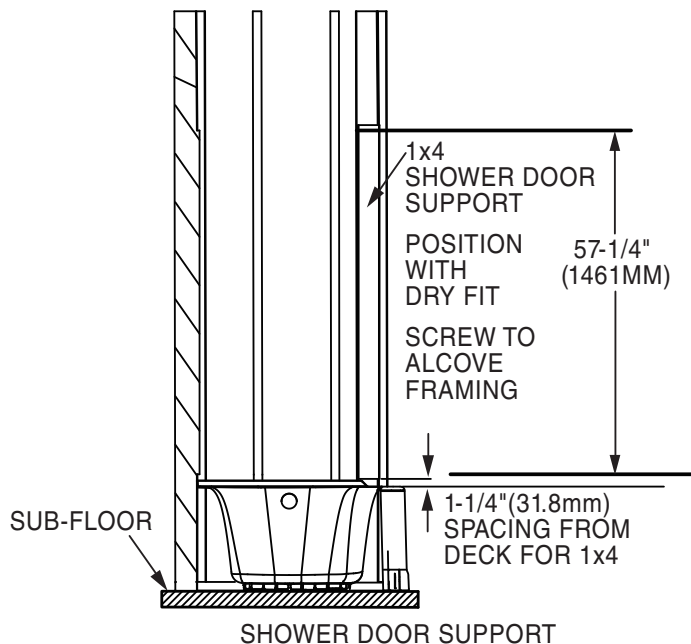
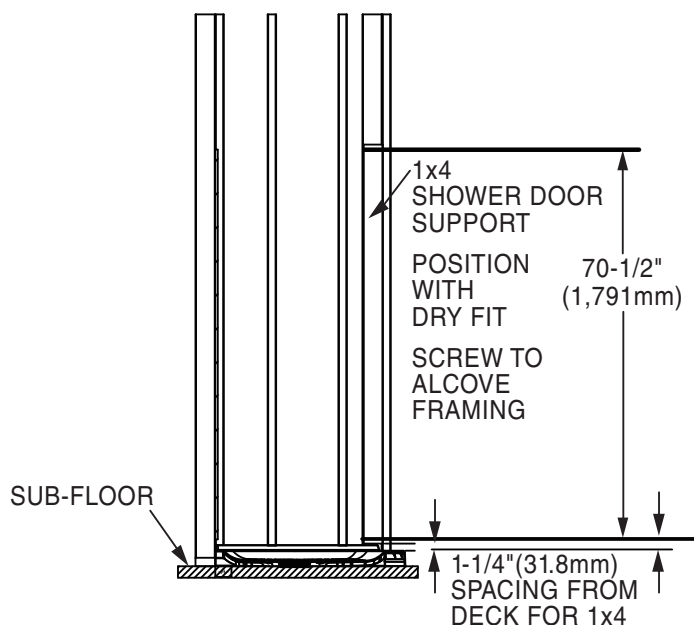

**2.** When installing a 1x4" keep it 1-1/4" (31.8 mm) off the deck of the tub or shower base and screw into alcove framing. (ref. illustration)

### 3

#### DRY FITTING SIDE WALLS

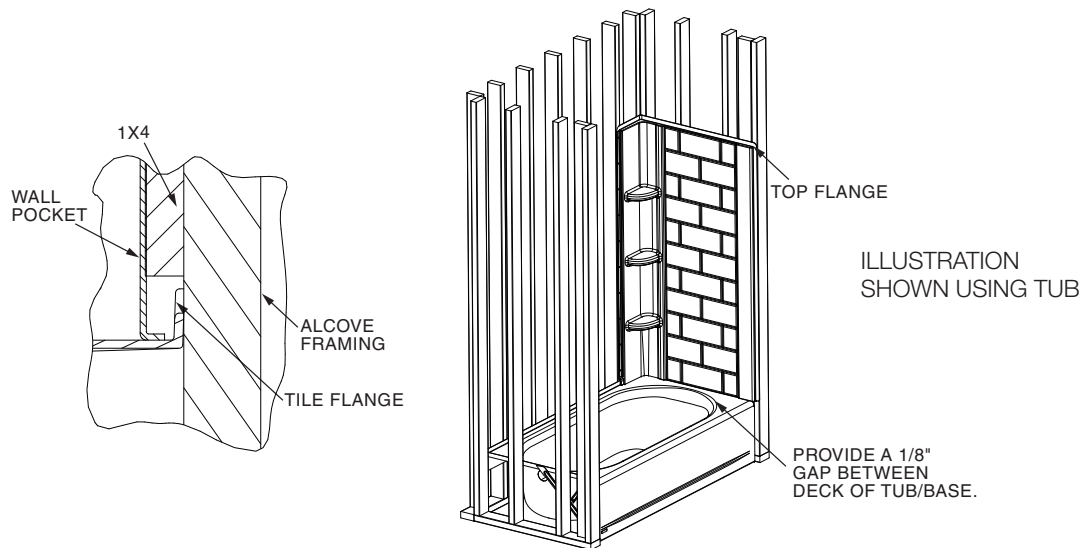

- 3a.** Place Side Wall into position in the alcove until corner is correctly in place, fitting squarely on top of tub or shower base with approximately a 1/8" gap. **TIP:** Can use paint mixing paddle as spacers for this. Using a level, verify vertical edges of the panels are plumb". Also verify that the 1x4" fits evenly within the Wall Pocket of each Side Wall. (ref left illustration above).
- 3b.** Starting with the Side Panel plumbed for fittings, mark all plumbing locations where shower valves or shower heads come through the Side Panel. Place tape over the area to be drilled to protect panel surface finish and drill holes at each location using hole saws large enough to accommodate the opening but small enough to be covered by the trim plates.
- 3c.** Once correctly in position and plumb, drill 11/64" pilot holes in the top flange and use 1 or 2 screws to temporarily hold the wall panel in place. **TIP:** After drilling clearance hole through the wall flange drill a pilot hole for #8 sharp point lath screw. This will prevent the screw from following wood grain and pulling wall out of alignment. Leave the corner of the Wall Panel free floating for the next steps. Dry fit the second Side Wall Panel in the same manner.

### 4

#### DRY FITTING REAR WALL

Once both Left & Right Side Wall Panels are correctly dry fitted, the Rear Wall Panel can be dry fitted.

**NOTE:** Long Extrusions will not be installed until after trial/dry fit.

- 4a.** Place the Rear Wall Panel between the Left and Right Side Panels. Check that there is no gap between the Rear and Side Wall Panels. If there is a gap between either Side Wall Panel and the Rear Wall Panel or the Rear Wall Panel does not fit between the Side Wall Panels, it will be necessary to re-adjust the Side Panel(s) to ensure the proper fit. **NOTE:** Full length shims or furring strips may be necessary behind one or both side panels to ensure proper spacing for back panel alignment. Alcove rough sizes vary, please take care to dry fit and verify this prior to final installation.

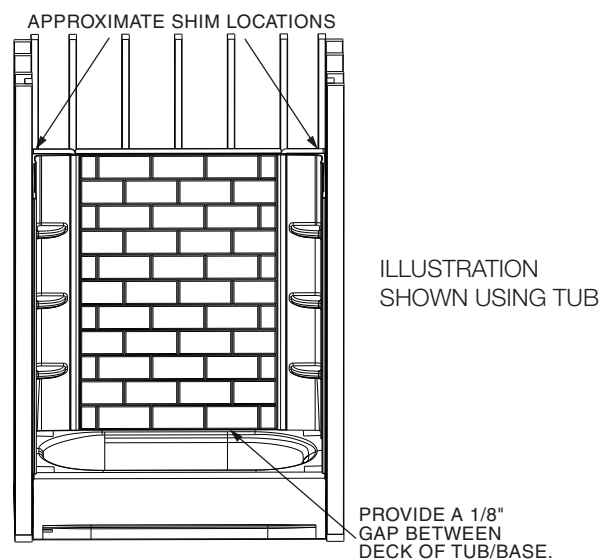

## 5

### FINAL DRY FIT

- 5a.** Once all the panels are dry fitted correctly in place with no gaps, secure the bottom of each side panel to the tub or shower base with tape.
- 5b.** Remove the Rear Wall Panel and mark both Left and Right Wall Panel locations, top and bottom, so when the Side Panels are removed for the addition of adhesive on the studs, the panels can be returned back to the same locations.
- 5c.** Unscrew and remove both Left and Right Side Panels.

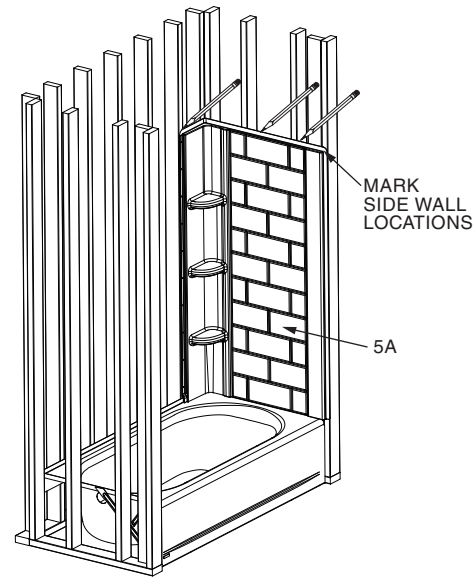

## 6

### APPLICATION OF ADHESIVE, SIDE PANELS

- 6a.** Measure and draw a line 58" from deck of tub or 70" for a shower base up each 2x4 that will contact rear side of wall panel. The line will provide a location where to apply adhesive. Starting with either Left or Right Side Panel, apply adhesive with at least 1/4" bead on the outside edges of studs that will contact back side of panel 58" for a tub or 70" for a shower base. Also add adhesive over the 1x4".
- 6b.** Install the Side Panel back into the previously marked position from step 5, check for plumb and screw panel back in place.
- 6c.** Press on the outside surface of the panel in the area where the adhesive is applied to ensure good contact of the adhesive to the inside of the Side Wall Panel. Install the opposite Side Panel in the same manner.

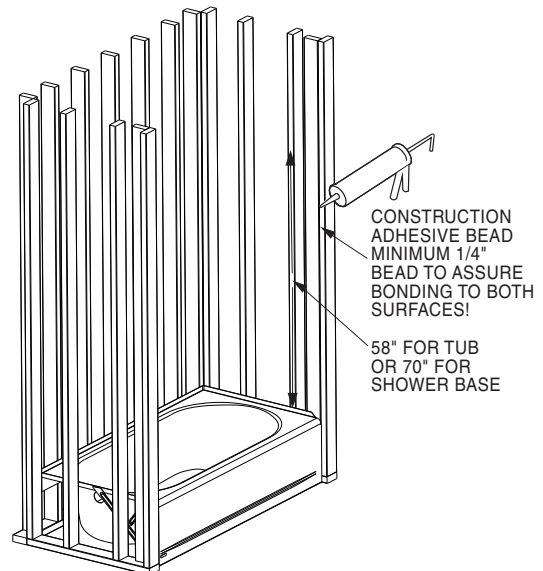

## INSTALLATION OF EXTRUDED WALL CONNECTORS

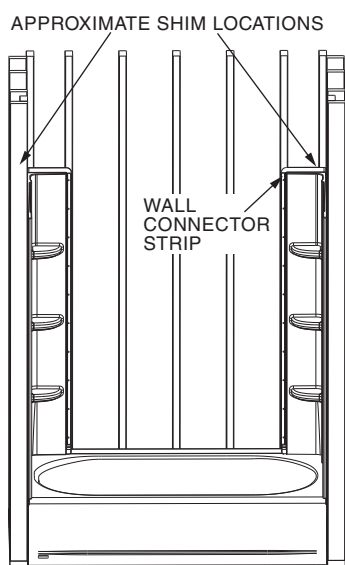

FIG. A

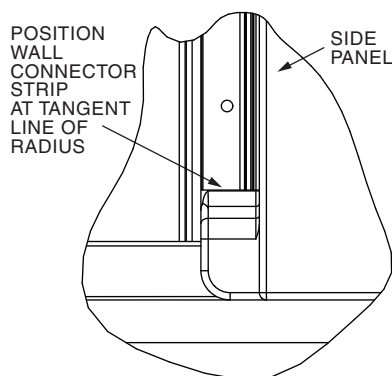

FIG. B  
WALL CONNECTOR PLACEMENT

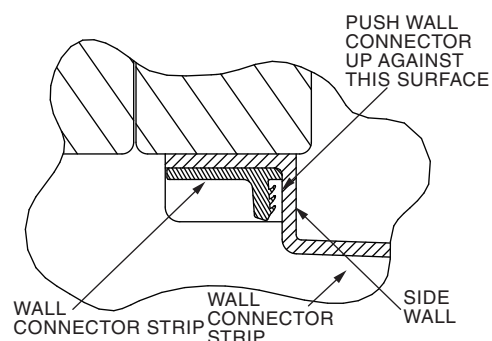

FIG. C  
CUTAWAY VIEW LOOKING  
DOWN FROM TOP

- 7a.** Remove one of the Extruded Wall Connectors and place onto the inside edge of one of the Side Wall Panels as illustrated (Fig. A). **Note:** Ensure the Wall Connector installs and fits correctly over the "Required" stud as illustrated (Fig. B & C). Butt the barbed side of the Wall Connector against the Side Wall surface. Use tape to hold Wall Connector in place, then pre-drill the wall panel flange using an 11/64" drill bit through each pre-drilled hole of the Wall Connector. **Note:** It is highly recommended that you drill a pilot hole into the wooden stud for each screw as well to prevent connector from shifting.
- 7b.** Secure Panel and Wall Connector using #8 Sharp point lath screw 1" long or longer through each hole. If using other type of screw ensure it has a washer head of approximately 7/16" diameter and rated for exterior wet locations use. **Note:** It is not recommended to use a powered drill for the last few turns of the screw; use a hand screwdriver instead or possible distortion of the Extruded Wall Connector may exist, making inserting the Rear Wall Panel difficult. Install the second Wall Connector in the same manner on the opposite Side Panel.
- 7c.** Once both Wall Connectors are securely screwed in place, complete the dry fit process of the Rear Wall Panel to the Side Wall Panels. Hold Rear Wall Panel up in position without pushing side into Wall Connectors and check that it fits the same as during the dry-fit stage. Check that the Rear Wall Panel fits correctly into the Extruded Wall Connectors with no gaps. **Note:** Applying a small amount of water to the joint of the Wall Connector will make inserting the Rear Wall Panel easier to do.



8

## APPLICATION OF ADHESIVE, REAR PANEL

CONSTRUCTION ADHESIVE SHOULD NOT BE APPLIED WHERE SIDE WALL FLANGES ARE SCREWED INTO STUDS WITH SEAL EXTRUSIONS. ALL OTHER STUDS REQUIRE CONSTRUCTION ADHESIVE APPLIED AT MINIMUM 1/4" BEAD SIZE ONLY APPLIED TO ASSURE PROPER BONDING OF WALLS TO STUDS.

58" FOR TUB  
OR 70" FOR A  
SHOWER BASE

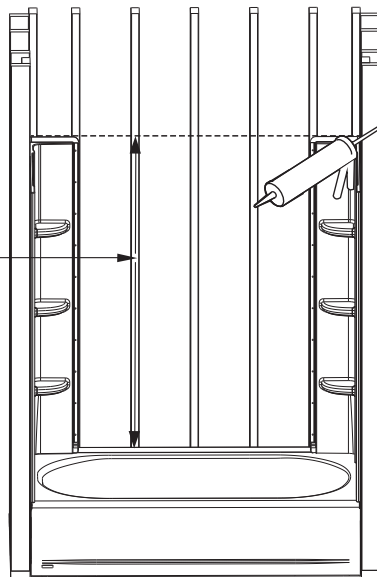

Measure and draw a line 58" from deck of tub or 70" for a shower base up each 2x4 that will contact rear side of wall panel.

The line will provide a location where to apply adhesive. **NOTE:** Do not apply adhesive on "Required Studs". Once all panels are correctly in position, remove the Rear Wall Panel and apply adhesive on outer edges of each 2x4 that come into contact with the rear side of panel as illustrated. Reinstall the Rear Wall Panel back into position and snap into place over the Side Wall Panels. When correctly snapped into position, screw Rear Panel in place on the top flange area into each stud using #8 sharp point lath screw 1" long or longer.

**NOTE:** It may be necessary to apply bracing to the wall areas where the walls contact the adhesive to ensure good contact. Wait 24 hours before applying sealant to joint areas as noted in step 9 below.

9

## APPLICATION OF SEALANT

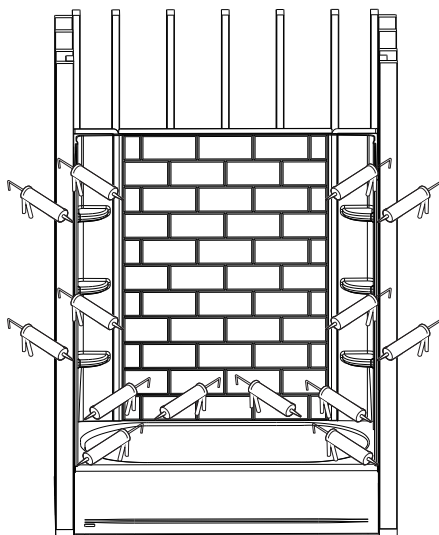

After waiting 24 hours for adhesive to cure from step 8, remove any bracing that may have been installed and apply sealant to all areas as illustrated. Allow 24 hours to cure before using.

*American Standard*

## POST INSTALLATION CLEAN-UP

Remove all construction debris. Install any accessories, shelves or doors according to manufacturer's installation instructions.

Post installation clean-up can be completed using 50/50 mixture of isopropyl alcohol and water.

### AFTERCARE AND CLEANING

**⚠ WARNING:** Cleaning products with labels that say "not suitable for use with ABS, acrylic or polystyrene" SHOULD NOT BE USED. Read all labels carefully.

Clean shower walls with warm soapy water and soft sponge. For stubborn stains, use a 50/50 mix of isopropyl alcohol and water.

HARSH CHEMICALS SHOULD NEVER BE USED ON SHOWER WALL SURFACE. Clean after use with a mild liquid household detergent cleaner. **Do not use** Lestoil®, Lysol® Disinfectant (spray or concentrate), or Lysol® Basin, Tub and Tile Cleaner, Windex®, Mr. Clean®, Dow® Disinfectant Bathroom Cleaner, or cleaning products in aerosol cans.

Do not use wire brushes, knives or sharp objects to remove stains or other surface blemishes.

Abrasive cleaners or powders should not be used as they will dull the surface.

Do not allow nail polish remover, acetone, paint remover or other solvents to come into contact with the surface.

# TELL US WHAT YOU THINK!

Please leave us a product review or story  
at **AmericanStandard.com/reviews**

Find installation videos at  
**youtube.com/americanstandard**

Register your warranty and sign up for an idea-filled newsletter at  
**AmericanStandard-us.com/support/warranty**

## PLEASE COMPLETE AMERICAN STANDARD WARRANTY REGISTRATION PROCESS AND

### SAVE THIS WARRANTY INFORMATION IMPORTANT:

Registration of the sink must be completed for this warranty to become effective. Your registration will make it easier to contact you in the event of a product recall.\*

**INSTRUCTIONS:** Register your sink at [www.americanstandard.com](http://www.americanstandard.com). Please save your proof of purchase (sale receipt). If you need assistance or do not have access to our website, please contact American Standard Customer Care at: (800) 442-1902. An American Standard representative will assist in completing the warranty registration.

\*In California, your warranty rights remain intact even if you do not complete the registration process.



## SHARE YOUR NEW PRODUCT!

Tag us @american\_standard on Instagram  
and show us how your new product looks.

## ≡ WANT MORE INFO?

For questions or help call us at **855-815-0004**,  
or visit **AmericanStandard.com**

### UNITED STATES

American Standard Brands  
865 Centennial Ave.  
Piscataway, New Jersey 08854  
Attention: Director of Customer Care  
For residents of the United States,  
warranty information may also be  
obtained by calling the following  
toll free number: (855) 815-0004  
[www.AmericanStandard.com](http://www.AmericanStandard.com)

### CANADA

LIXIL Canada, Inc.  
5900 Avebury Rd.  
Mississauga, Ontario  
Canada L5R 3M3  
Toll Free: (800) 387-0369  
[AmericanStandard.ca/support/warranty](http://AmericanStandard.ca/support/warranty)

### MEXICO

American Standard B&K Mexico  
S. de R.L. de C.V.  
Via Morelos #330  
Col. Santa Clara  
Ecatepec 55540 Edo. Mexico  
Toll Free: 800-839-1200  
[AmericanStandard.com.mx/garantia](http://AmericanStandard.com.mx/garantia)