

Replacement Parts

31810

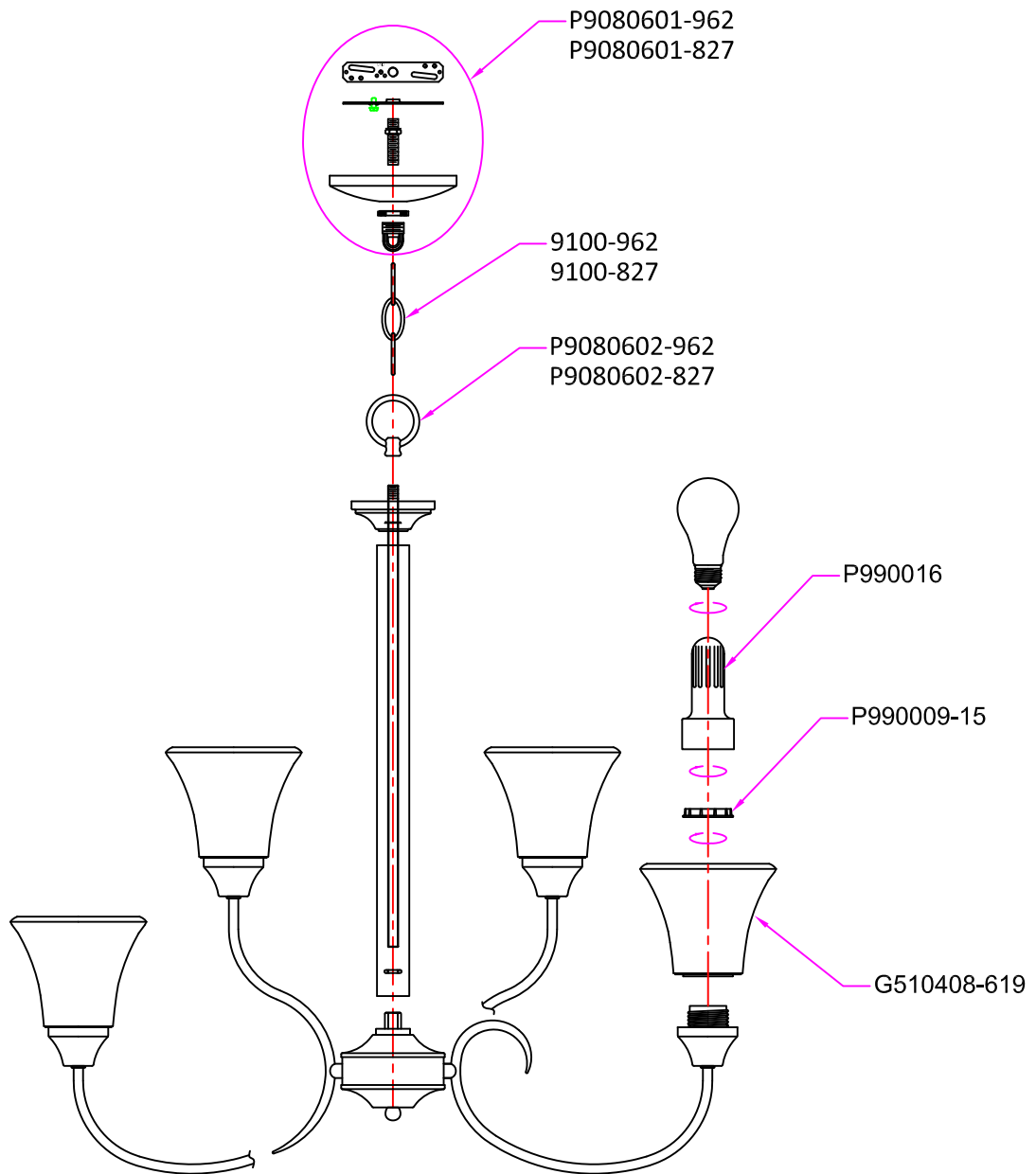

Qty.	Part #	Description
	P9080601-xxx	Canopy Kit, including mounting bar/nipple/hex nut/washer/canopy/screw collar
	9100-xxx	Standard Chain, 3.2mm thick, 72" long
	P9080602-xxx	Fixture Loop with 1/8 thread, Ø2 1/16"
	P990016	Glass ring tool, plastic, Black
	P990009-15	Metal Socket Ring, threads to match medium base socket, White
	G510408-619	Glass, Ø5 1/4", with 4 3/8" height

* Note: -xxx: Represents different finish and optional.
Available finish please see P/N shown in the drawing or catalog.

Sea Gull Lighting®

Life Illuminated | Since 1919

www.SeaGullLighting.com